

1

2

3

4

A

B

C

D

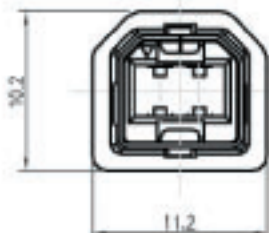
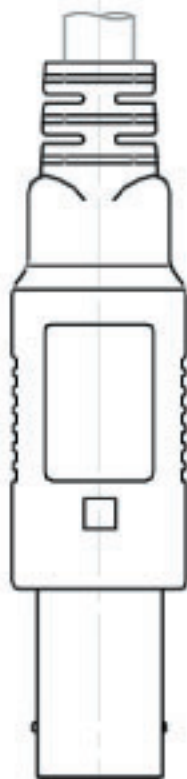
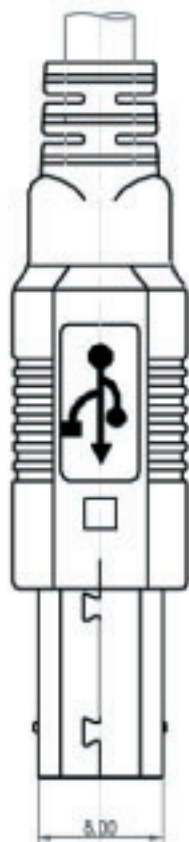

| REV. | DESCRIPTION | DRAWN/DATE | CHECK/DATE | APPROVED/DATE |
|------|----------------------------------|-----------------|--------------|--------------------|
| A | NEW RELEASE NPR-98007 | WELLEN 08/23/98 | Max 08/03/98 | JOHN CHEN 08/04/98 |
| B | REV. PER ECR-09053 Δ 1 | Starly 02/23/99 | Max 02/26/99 | JOHN CHEN 03/01/99 |
| C | REV. PER ECR-09292 Δ X4 | Starly 09/19/99 | Max 09/29/99 | JOHN CHEN 10/04/99 |
| D | REV. PER ECR-00101 Δ X1 | KELLY 02/24/00 | Max 02/25/00 | JOHN CHEN 02/25/00 |
| E | REV. PER SZEGR-00172 Δ X4 | WU 11/07/00 | TOM 11/16/00 | ROGER 11/17/00 |
| F | REV. PER SZEGR-01800 Δ X2 | JAO 08/23/01 | TOM 08/29/01 | MAX 08/29/01 |

NOTES :

- 1.0. RATING :
 - 1.1. VOLTAGE : 30 VAC (R.M.S.)
 - 1.2. CURRENT : 1.0 AMPERE MAXIMUM PER CONTACT AT 30°C T-RISE
 - 1.3. TEMPERATURE : -55°C TO +85°C UNLESS LIMITED BY CABLE OR OVERMOLD (-40°C TO +60°C STORAGE ;+0°C TO +40°C OPERATING)
- 2.0. ELECTRIC CHARACTERISTIC :
 - 2.1. CONTACT RESISTANCE : 30 MILLIOHMS MAXIMUM INITIAL
 - 2.2. INSULATION RESISTANCE : 1,000 MEGOHMS MINIMUM
 - 2.3. DIELECTRIC WITHSTANDING VOLTAGE : 500 VAC AT SEA LEVEL
- 3.0. MATERIALS : ABS RESIN, UL 94V-0 RATED
- 4.0. OTHERS :
 - 4.1. ALL PART MUST BE PURCHASED SEPARATELY (REFER TO TABLE B)
 - 4.2. PRODUCT NUMBERING CODE: REFER TO TABLE A

| | | | | |
|---|--------------------------------|-----------|----------|---|
| GENERAL TOLERANCE | ANGLE TOLERANCE | DRAWN | DATE | ASSMANN Electronics, Inc. |
| X ±0.38 J ±0.25 JK ±0.13 JKK ±0.05 | K ±0.07 J ±0.07 JK ±0.07 | WELLEN | 07/31/98 | |
| FINISH SEE NOTES | WTL SEE NOTES | DESIGN | DATE | TITLE A-USBPB-HOOD USB B TYPE HOOD |
| SCALE 3 : 1 | UNIT MM | MAX YANG | 04/10/98 | |
| SHEET 1 OF 2 | | CHECKED | DATE | SERIES USB B TYPE SERIES |
| | | MAX YANG | 08/03/98 | SIZE A3 |
| | | APPROVED | DATE | DRAWING NO. CI-LIBCT2-00-00 |
| | | JOHN CHEN | 08/04/98 | REV. F |

1

2

3

4

A

B

C

D

1

2

3

4

A

A

B

B

C

C

D

D

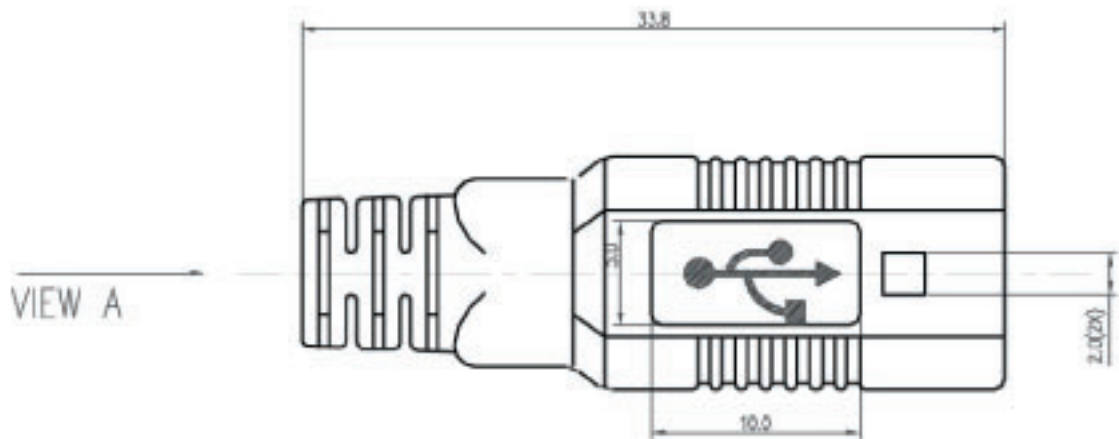

CABLE EXIT: TYPE I
(RECOMMENDED CABLE OD=#3.4~#3.8)



CABLE EXIT: TYPE II
(RECOMMENDED CABLE OD=#3.9~#4.6)

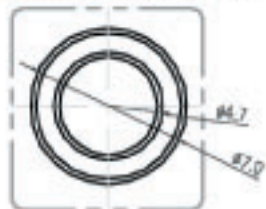

CABLE EXIT: TYPE III
(RECOMMENDED CABLE OD=#4.7~#5.3)



△ CABLE EXIT: TYPE IV
(RECOMMENDED CABLE OD=#4.5~#4.9)



VIEW A

| GENERAL TOLERANCE | ANGLE TOLERANCE | DRAWN | DATE |
|-------------------|-----------------|-----------|----------|
| X ±0.28 | X ±30° | WELLEN | 07/31/98 |
| J ±0.25 | F ± | DESIGN | DATE |
| JX ±0.13 | XF ±1.0° | MAX YANG | 04/10/98 |
| JK ±0.08 | XF ±1.0° | CHECKED | DATE |
| | | MAX YANG | 08/03/98 |
| W/L SEE NOTES | UNIT DIM | APPROVED | DATE |
| FINISH SEE NOTES | | JOHN CHEN | 08/04/98 |
| SCALE 3 : 1 | | | |
| SHEET 2 OF 2 | | | |

| | | | |
|-------------------------------------|--|--------|--|
| ASSMANN Electronics, Inc. | | TITLE | A-USBPB-HOOD USB B TYPE HOOD |
| | | SERIES | |
| DRAWING NO. CI-UBC12-00-00 | | SIZE | A3 |
| | | REV | 7 |

1

2

3

4