

TRANSISTOR INSULATORS

- Rapid Heat Dissipation • High Dielectric Strength • Low Cost

These precision stamped mica insulators provide good thermal conductivity: Excellent thermal resistance 1100°F. (593°C) Dielectric constant of 7 at 1000 KHz. .009 watts per square inch per degree celsius per inch in thickness.

MATERIAL: .003 (.08) ± .001 (.02) Thick Mica

FOR TO-3 CASES

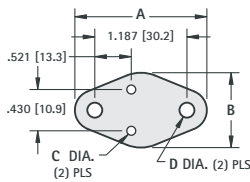

| CAT. NO. | A | B | C | D |
|----------|--------------|--------------|-------------|------------|
| 4651 | 1.625 (41.3) | 1.093 (27.8) | .093 (2.36) | .166 (4.2) |
| 4652 | 1.560 (39.6) | 1.050 (26.7) | .203 (5.15) | .171 (4.4) |
| 4653 | 1.655 (42.1) | 1.063 (27.0) | .166 (4.2) | .166 (4.2) |
| 4636 | 1.655 (42.1) | 1.063 (27.0) | .052 (1.32) | .166 (4.2) |
| 4644 | 1.655 (42.1) | 1.063 (27.0) | .270 (6.9) | .166 (4.2) |

FOR THREADED STUD TRANSISTORS

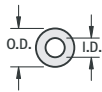

| CAT. NO. | ID | OD | For Screw Size |
|----------|------------|-------------|----------------|
| 4678 | .120 (3.1) | .375 (9.5) | 4 |
| 4679 | .144 (3.7) | .375 (9.5) | 6 |
| 4680 | .171 (4.3) | .500 (12.7) | 8 |
| 4681 | .196 (5.0) | .625 (15.9) | 10 |
| 4682 | .260 (6.6) | .750 (19.0) | 1/4 |
| 4683 | .328 (8.3) | .875 (22.2) | 5/16 |

FOR TO-66 CASES

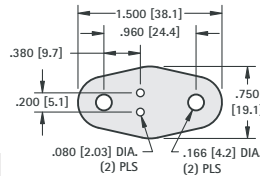

CAT. NO. 4664

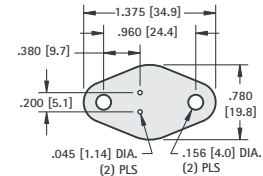

CAT. NO. 4666

FOR TO-3 CASES

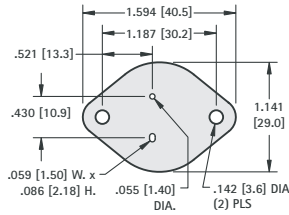

CAT. NO. 4662

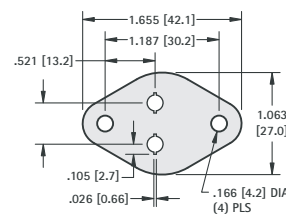

CAT. NO. 4667

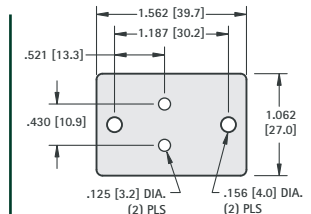

CAT. NO. 4661

PLASTIC CASES

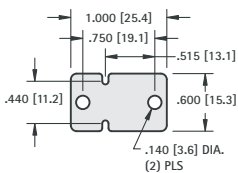

CAT. NO. 4663

FOR TO-220 CASE (2-PIN)

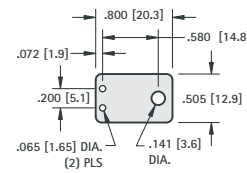

CAT. NO. 4671

FOR TO-220 CASE (3-PIN)

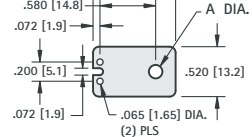

| CAT. NO. | A |
|----------|------------|
| 4672 | .141 (3.6) |
| 4673 | .115 (2.9) |

TRANSISTOR MOUNTING KITS

- Complete Kits or Individual Hardware • Pre-Packaged • Uniform Hardware at Low Cost

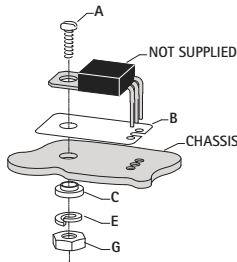

FOR TO-220 CASE

| CAT. NO. 4724 Complete Mounting Kit | | | |
|-------------------------------------|----------|-----------------|------|
| ITEM | CAT. NO. | DESCRIPTION | QTY. |
| A | 4690 | 4-40 Screw | 1 |
| B | 4672 | Mica Insulator | 1 |
| C | 3049 | Shoulder Washer | 1 |
| E | 4693 | Lockwasher | 1 |
| G | 4694 | 4-40 Nut | 1 |

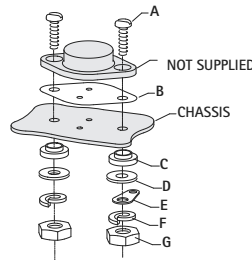

FOR TO-3 CASE

| CAT. NO. 4725 Complete Mounting Kit | | | |
|-------------------------------------|----------|-----------------|------|
| ITEM | CAT. NO. | DESCRIPTION | QTY. |
| A | 4696 | 6-32 Screw | 2 |
| B | 4651 | Mica Insulator | 1 |
| C | 4698 | Shoulder Washer | 2 |
| D | 4699 | Metal Washer | 2 |
| E | 4004 | Solder Terminal | 1 |
| F | 4700 | Lockwasher | 2 |
| G | 4701 | 6-32 Nut | 2 |

FOR TO-66 CASE

| CAT. NO. 4726 Complete Mounting Kit | | | |
|-------------------------------------|----------|-----------------|------|
| ITEM | CAT. NO. | DESCRIPTION | QTY. |
| A | 4696 | 6-32 Screw | 2 |
| B | 4666 | Mica Insulator | 1 |
| C | 4698 | Shoulder Washer | 2 |
| D | 4699 | Metal Washer | 2 |
| E | 4004 | Solder Terminal | 1 |
| F | 4700 | Lockwasher | 2 |
| G | 4701 | 6-32 Nut | 2 |

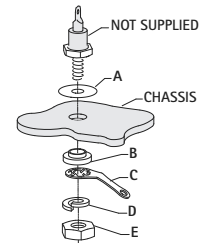

FOR DO-4, TO-59, TO-60, TO-62 CASES

| CAT. NO. 4729 Complete Mounting Kit | | | |
|-------------------------------------|----------|-----------------|------|
| ITEM | CAT. NO. | DESCRIPTION | QTY. |
| A | 4681 | Mica Insulator | 2 |
| B | 4702 | Shoulder Washer | 1 |
| C | 4704 | Solder Terminal | 1 |
| D | 1477 | Lockwasher | 1 |
| E | 4705 | 10-32 Nut | 1 |

FOR DO-5, TO-48, TO-61 CASES

| CAT. NO. 4730 Complete Mounting Kit | | | |
|-------------------------------------|----------|-----------------|------|
| ITEM | CAT. NO. | DESCRIPTION | QTY. |
| A | 4682 | Mica Insulator | 1 |
| B | 4711 | Shoulder Washer | 1 |
| C | 4712 | Solder Terminal | 1 |
| D | 1476 | Lockwasher | 1 |
| E | 4713 | 1/4-28 Nut | 1 |

These pre-packaged universal mounting kits provide all the necessary hardware and insulators required to securely mount the semiconductor to the chassis. Purchase the complete kit consisting of all hardware included in one package. Your choice of individual items available in 100 piece packages. Semiconductors customer supplied.