

M 2:1

Leiterplattenbohrbild  
PCB drillhole pattern

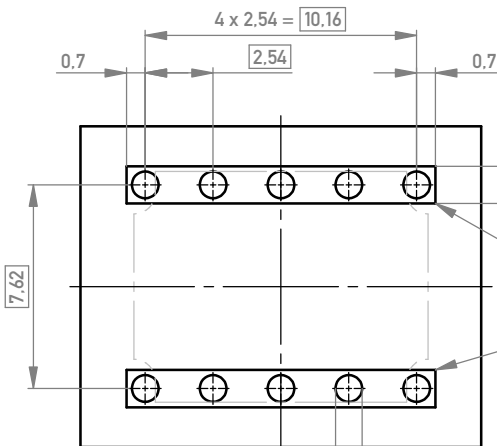

Dieser Bereich muß gleiches Potential auf der LP-Oberfläche haben

*This area must have same electrical potential on surface of PCB*

$\varnothing 0.05$   $\varnothing 1 \pm 0.1$

alle Löcher/  
all holes

214786	M4
214785	M3
214784	6-32UNC
214783	8-32UNC
Id.-Nr.: Part No.	Gewinde Thread

Copyright by ERNI GmbH Proprietary notice pursuant to ISO 9006 to be observed.	Information:	Tolerances	All Dimensions in mm	Scale	5:1
	All rights reserved. Only for Information. To ensure that this is the latest version of this drawing, please contact one of the ERNI companies before using.	Subject to modification without prior notice. Drawing will not be updated.		Designation	<b>SVA 10-polig TL</b> <b>Power Bug 10 pin TL</b>
d Index	23.11.2020 Date		www.ERNI.com	204819	I A3
				Class	EPSVA