



**ANATECH ELECTRONICS INC**  
RF & Microwave Filters & Products

# 428 MHz LC Band Pass Filter

**Part Number: AE428B6224**



## Electrical Specifications

**Center Frequency:** 428 MHz  
**Passband:** 406-450 MHz  
**Insertion Loss:** 3.0dB Max.  
**Return Loss:** 14dB Min.  
**Rejection1:** ≥ 30dB @ 370 MHz  
**Rejection2:** ≥ 30dB @ 478 MHz

## Mechanical

**Connector Type:** PC-Mount  
**Dimensions:** 1.5" X 0.75" x 0.5" .

## Environmental

**Operating Temperature:** -25°C to +70°C  
**Storage Temperature:** -40°C to +90°C  
**Shock:** 10 G. 11ms  
**Vibration:** 10 G. 5 to 200Hz

## Outline Drawing:

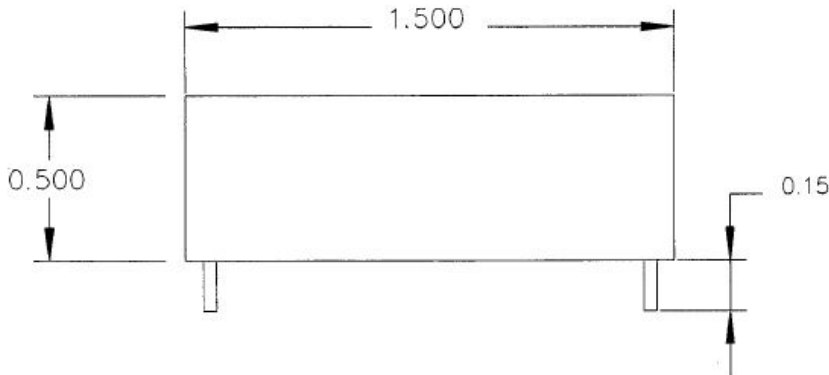

IN/OUT pin 0.02" dia, GND pin 0.04" dia

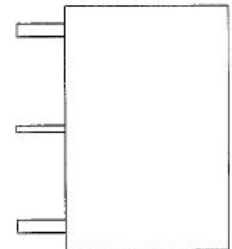
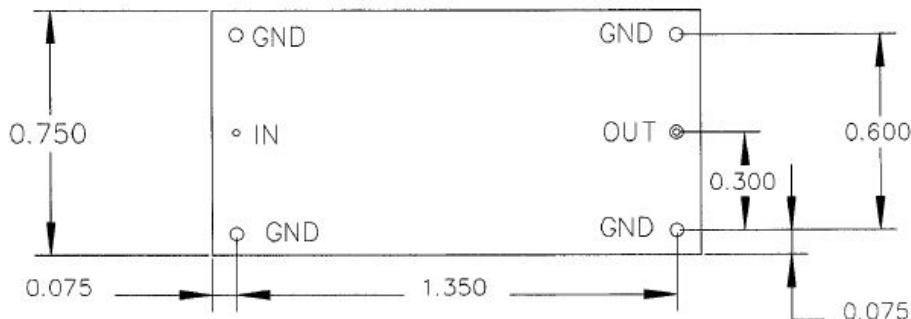



**ANATECH ELECTRONICS INC**  
RF & Microwave Filters & Products

# 428 MHz LC Band Pass Filter

Part Number: AE428B6224



## Response Plot:

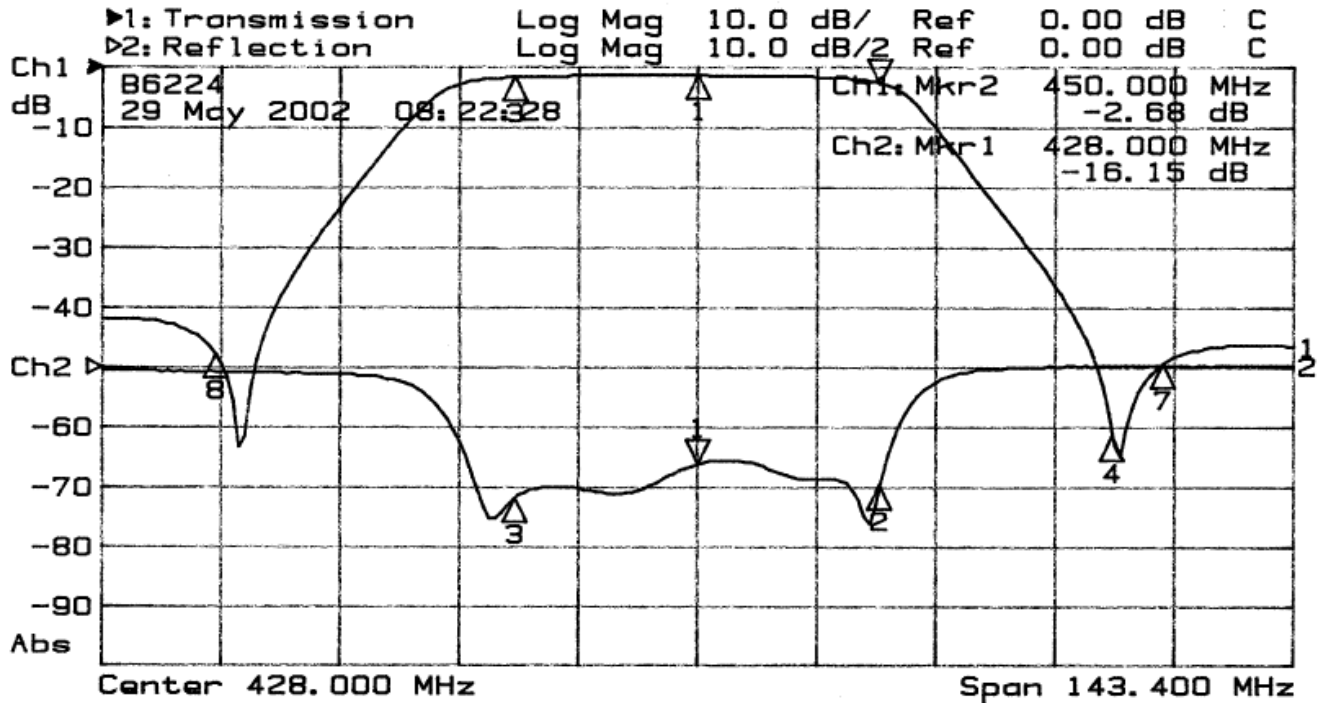

1: Mkr (MHz)	dB	2: Mkr (MHz)	dB
1: 428.00	-1.40	1> 428.00	-16.15
2> 450.00	-2.68	2: 450.00	-19.77
3: 406.00	-1.62	3: 406.00	-21.81
4: 478.00	-61.71		
7: 484.00	-49.41		
8: 370.00	-47.96		