



ANATECH ELECTRONICS INC
RF & Microwave Filters & Products

Cellular 900 MHz Bandpass

Part Number: AB915B494



Electrical specifications

Center Frequency: 915 MHz
Bandwidth: 26 MHz
Input / Output Impedance: 50 Ohms
Passband: 902-928 MHz
Passband Insertion Loss: 1.5dB
Passband Ripple: <0.2 dB
Passband Return Loss: 20dB
Rejection @ 850~894MHz: >45dB
Rejection @ 936~950MHz: >45dB
Power Handling: 30 W

Mechanical

Mounting Method: Threaded Mounting Holes
Connector Type: N-Type Female
Dimensions: 120 x 60 x 48 mm

Environmental

Operating Temperature: -45 to +85 deg.C
Storage Temperature: -55 to +95 deg.C
Shock: 20 G. 11ms
Vibration: 20 G. 5 to 200 Hz

Outline Drawing:

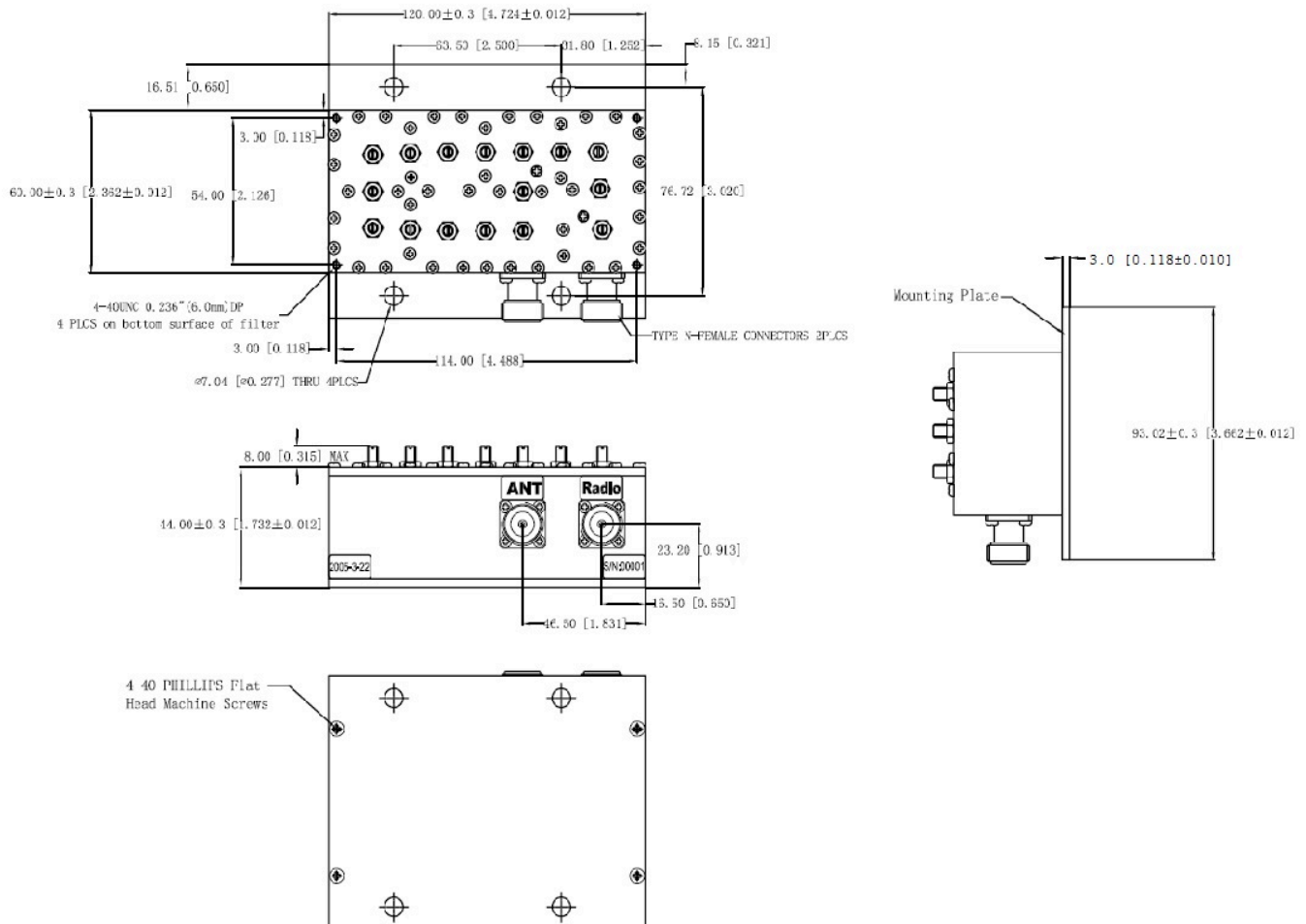

Tolerance: +/-0.01 inches [+/- 0.3mm]

Angles: +/- 1 Deg.

*Tolerance as shown unless otherwise specified in the datasheet electrical specification tables above.

*When max dimensions are called out the above tolerances do not apply as long as it is under the max call out.



ANATECH ELECTRONICS INC
RF & Microwave Filters & Products

Cellular 900 MHz Bandpass

Part Number: AB915B494



Response Plot:

