



ANATECH ELECTRONICS INC
RF & Microwave Filters & Products

650 MHz Bandpass Filter

Part Number: AE650B6439



Electrical Specifications

Center Frequency: 650 MHz
Passband: <3 dB @ 325 MHz to 675 MHz
Ripple: >0.1dB
Insertion Loss: <2 dB
Impedance: 50 Ohms
Rejection: > 35 dB @ 600 MHz
Rejection: > 60 dB @ 750-825 MHz

Mechanical

Connector Type: Surface Mount
Dimensions: 1.5" X 0.5" x 0.4" in.

Environmental

Operating Temperature: -25°C to +70°C
Storage Temperature: -40°C to +90°C
Shock: 10 G. 11ms
Vibration: 10 G. 5 to 200Hz

Outline Drawing:

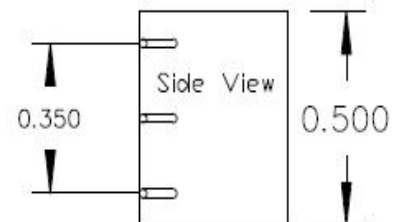
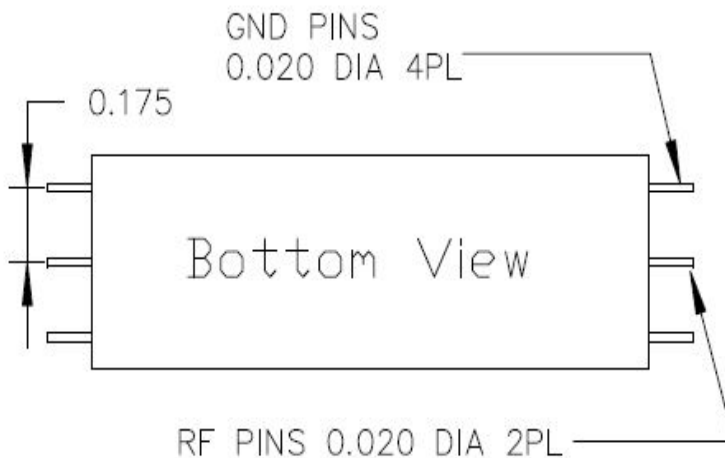
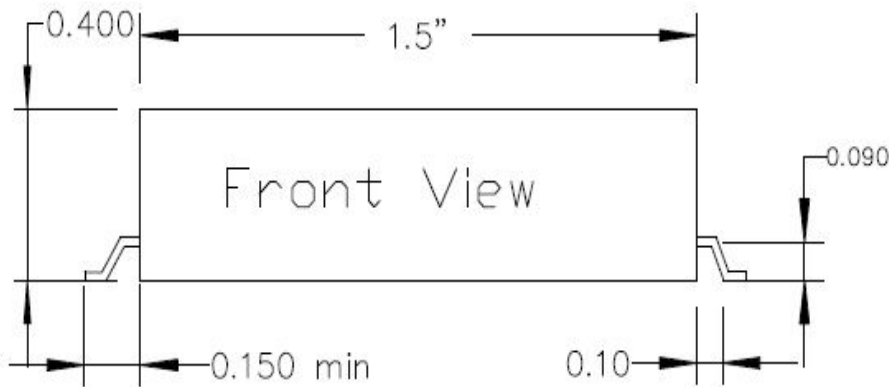



ANATECH ELECTRONICS INC
RF & Microwave Filters & Products

650 MHz Bandpass Filter

Part Number: AE650B6439



Response Plot:

B6439.lad

Attenuation/Return Loss

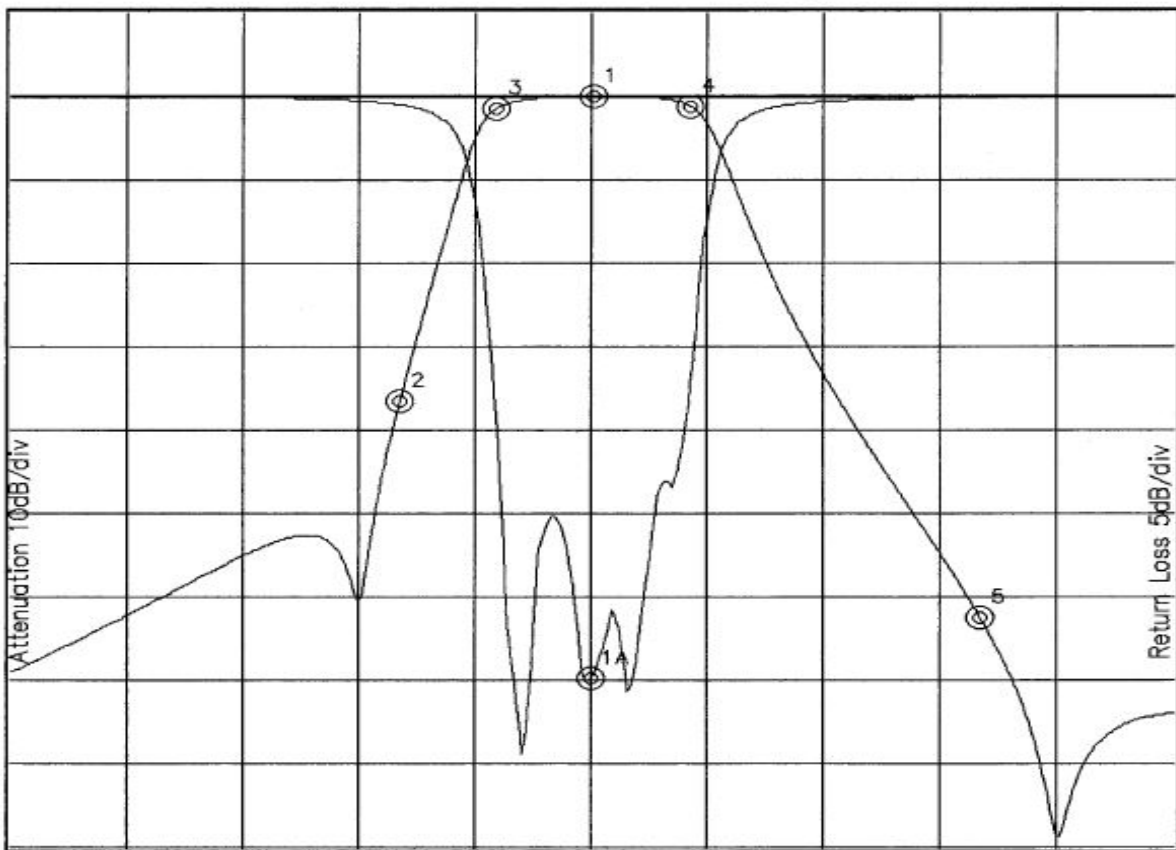

Attenuation Start: 500.0MHz Stop: 800.0MHz

Return Loss Start: 500.0MHz Stop: 800.0MHz

Offset -1.7391dB

Marker 1 Freq 650.24MHz Atten -0.025dB
Marker 2 Freq 600.32MHz Atten -36.727dB
Marker 3 Freq 625.04MHz Atten -1.501dB
Marker 4 Freq 675.44MHz Atten -1.220dB
Marker 5 Freq 750.08MHz Atten -62.794dB

Marker 1A Freq 649.75MHz Ret Loss -35.093dB