



Electrical Specifications

Center Frequency: 141 MHz
Insertion Loss: 2.0 dB Max
Return Loss in Passband: 15 dB Min
Rejection: >40 dB @ 0-62 MHz
 >40 dB @ 220-2000 MHz

Mechanical

Connector Type: Drop-In Pins
Dimensions: 1.5 x 0.5 x 0.4 Inches

Environmental

Operating Temperature: -20 to +70° C
Storage Temperature: -40 to +85° C
Shock: 20 G. 11 ms
Vibration: 20 G. 5 to 200 MHz

Outline Drawing:

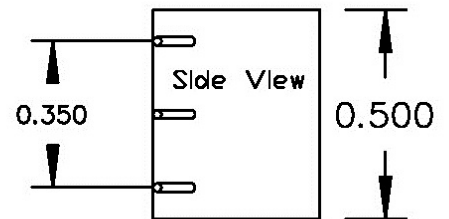
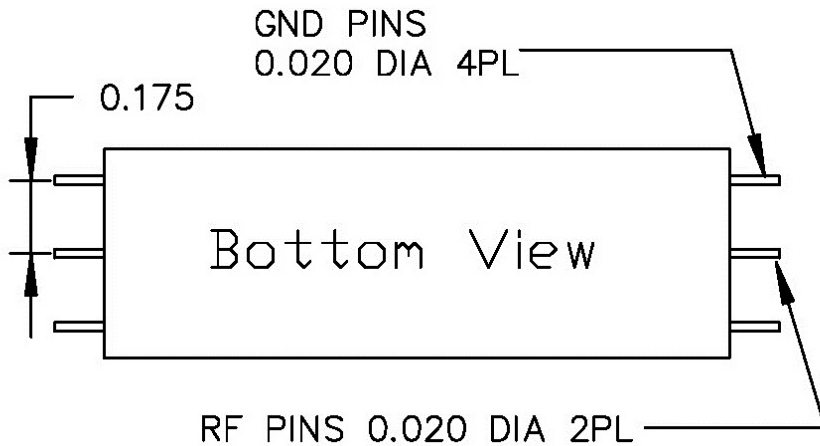
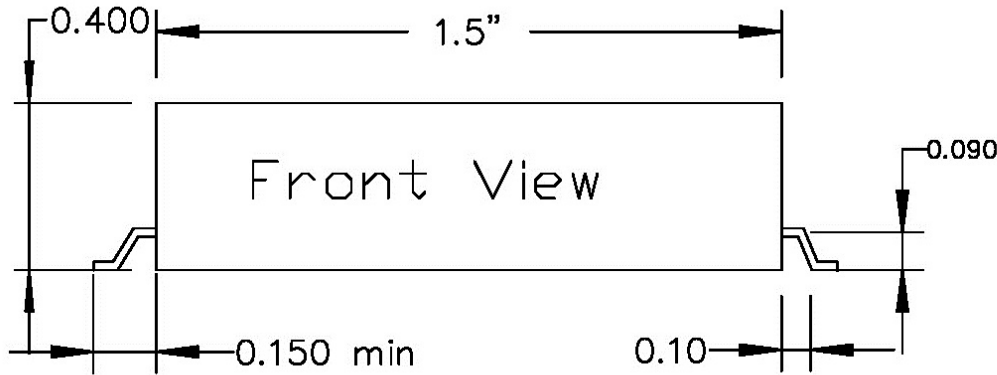



ANATECH ELECTRONICS INC
RF & Microwave Filters & Products

141 MHz LC Band Pass Filter

Part Number: AE141B9796



Response Plot:

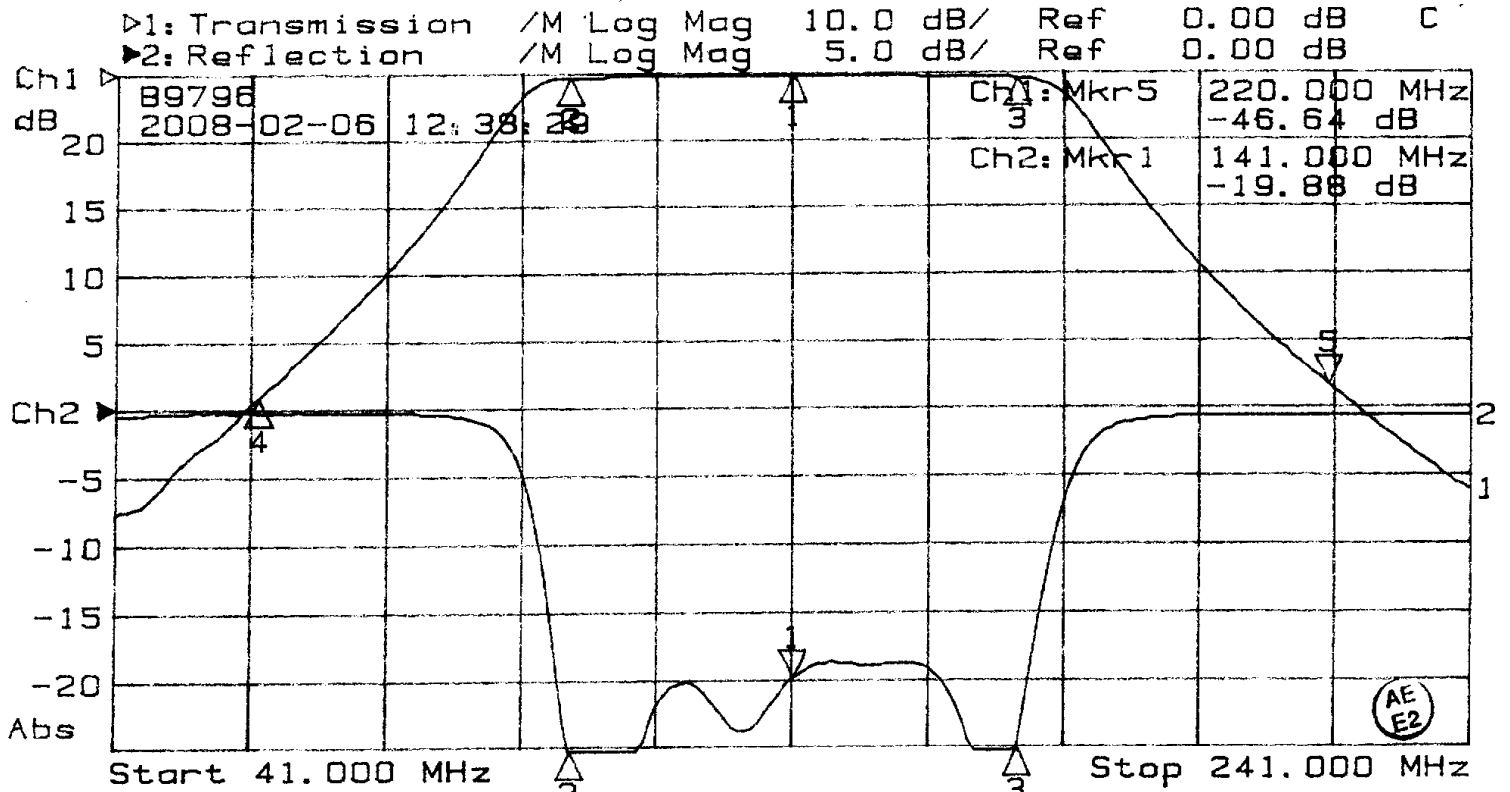

| 1: Mkr (MHz) | dB | 2: Mkr (MHz) | dB |
|--------------|--------|--------------|--------|
| 1: 141.00 | -0.34 | 1> 141.00 | -19.88 |
| 2: 108.00 | -0.62 | 2: 108.00 | -25.36 |
| 3: 174.00 | -0.81 | 3: 174.00 | -25.11 |
| 4: 62.00 | -48.51 | | |
| 5> 220.00 | -46.64 | | |

Handwritten signature: Kenneth D. ...