



**ANATECH ELECTRONICS INC**  
RF & Microwave Filters & Products

# 710 MHz LC Bandpass Filter

**Part Number: AE710B9360**



## Electrical Specifications

**Center Frequency:** 710 MHz  
**1-dB Passband :** 614 MHz to 806 MHz  
**Insertion Loss:** 1dB Max. @ 710 MHz  
**Return Loss:** 14dB Min. @ 614 MHz to 806 MHz  
**Impedance:** 50 Ohms

## Mechanical

**Connector Type:** SMA(Female)  
**Dimensions:** 2.50" x 1.125" x 0.750" in.

## Environmental

**Operating Temperature:** -25°C to +70°C  
**Storage Temperature:** -40°C to +90°C  
**Shock:** 10 G. 11ms  
**Vibration:** 10 G. 5 to 200Hz

## Outline Drawing:

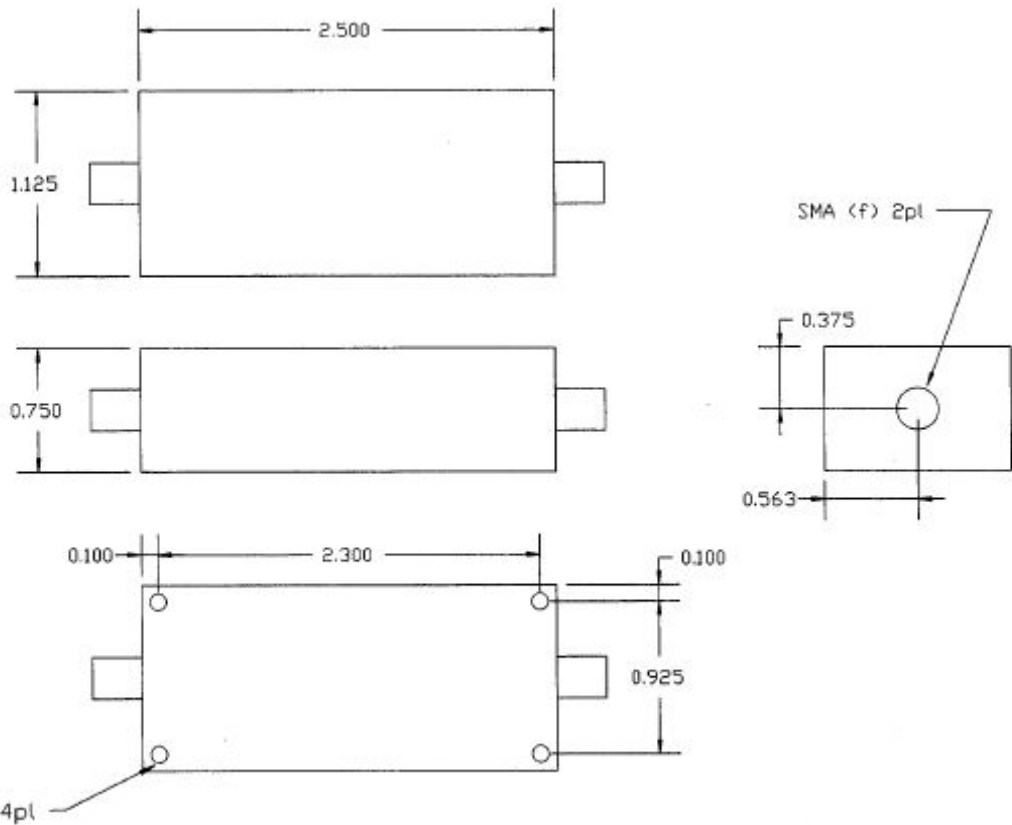

Tolerance: +/-0.01 inches [ +/- 0.3mm]  
Angles: +/- 1 Deg.

\*Tolerance as shown unless otherwise specified in the datasheet electrical specification tables above.

\*When max dimensions are called out the above tolerances do not apply as long as it is under the max call out.

**70 Outwater Lane Phone: (973) 772-4242**  
**Garfield, NJ 07026 Fax : (973) 321-3941**

**Email: [sales@anatechelectronics.com](mailto:sales@anatechelectronics.com)**  
**Web: [www.anatechelectronics.com](http://www.anatechelectronics.com)**



**Response Plot:**

