



ANATECH ELECTRONICS INC
RF & Microwave Filters & Products

35 GHz Cavity Band Pass Filter

Part Number: AE35000B11277



Electrical Specifications

Center Frequency: 35000 MHz
Bandwidth: 4000-6000 MHz
Insertion Loss: 2.0 dB Max
Group Delay: $\leq 0.1\text{ns}/20\text{ MHz}$ (within 4000 MHz)
Ripple In Band: $\leq 0.25\text{ dB}$ (within 4000 MHz)
VSWR: 1.30:1 Max
Impedance: 50 Ω
Rejection: $\leq 50\text{ dB}$ @ DC-25140 MHz
 $\leq 60\text{ dB}$ @ 25150-28850 MHz
 $\leq 50\text{ dB}$ @ 41000-50000 MHz
Power Handling: 10 dBm average
15 dBm peak

Mechanical

Connector Type: 2.92mm (F)
Dimensions: 27.0 x 16.0 x 7.5 mm

Environmental

Operating Temperature: -40 to +80° C
Storage Temperature: -50 to +95° C
Shock: 20 G. 11 ms
Vibration: 20 G. 5 to 200 MHz

Outline Drawing:

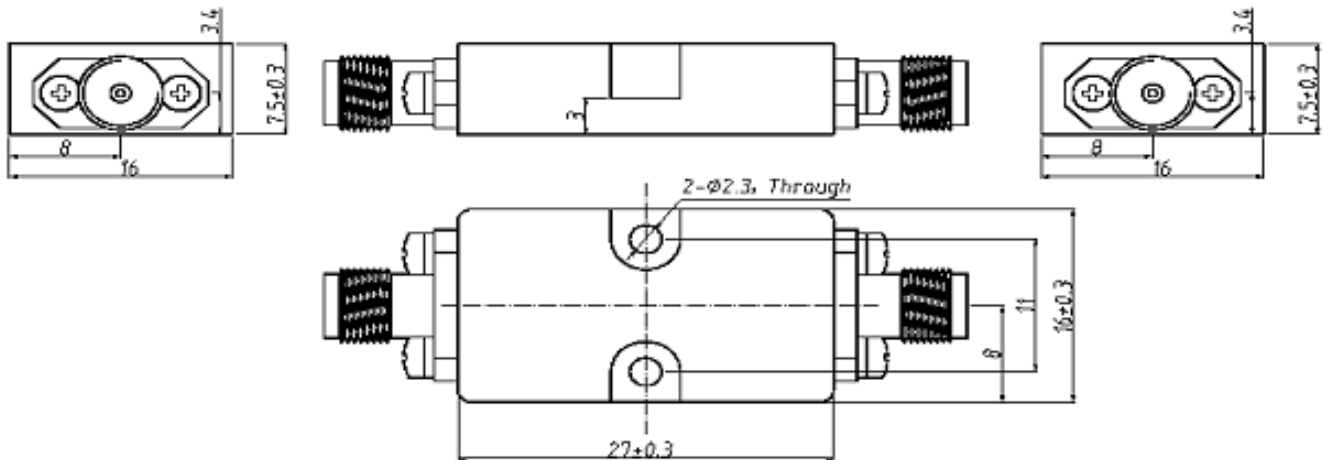



Response Plot:

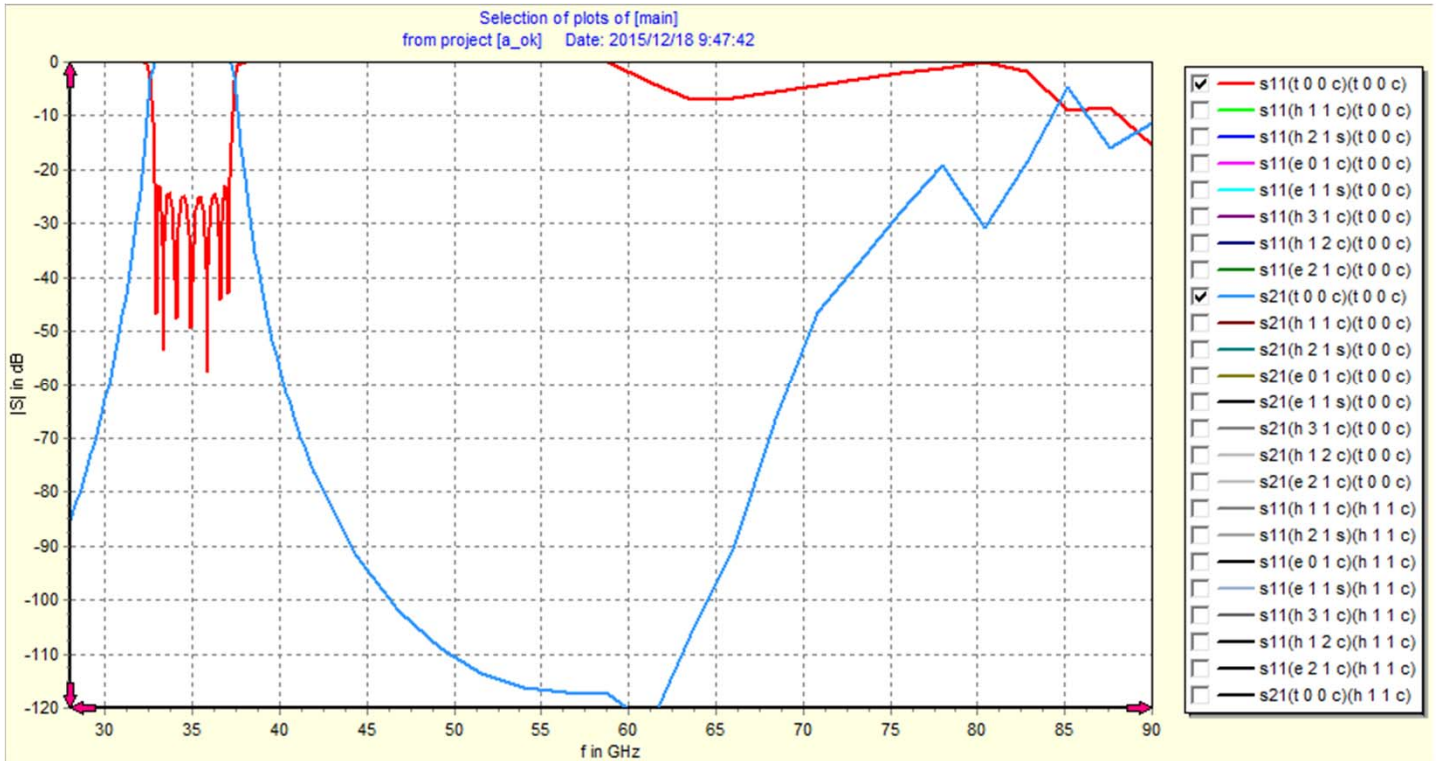

Note: This is a simulation plot. Actual results may differ once the product is implemented.