



# 365 MHz LC Bandpass Filter

**Part Number: AE365B6743**



## Electrical specifications

**Center Frequency:** 365 MHz  
**1dB Bandwidth:** 38 MHz  
**Passband:** 346-384 MHz  
**Insertion Loss:** 2 dB Max  
**Return Loss:** 14 dB Min  
**Ripple:** 0.1 dB  
**Rejection:** >20 dB @ 0-296 MHz  
                   >50 dB @ 692-1300 MHz  
**Power Handling:** 10 W

## Mechanical

**Dimensions:** 2.1 x 0.85 x 0.43 inches

## Environmental

**Operating Temperature:** -55 to +85° C  
**Shock:** 30 G. 11ms  
**Vibration:** 10 G. 5 to 1000 Hz

## Outline Drawing:

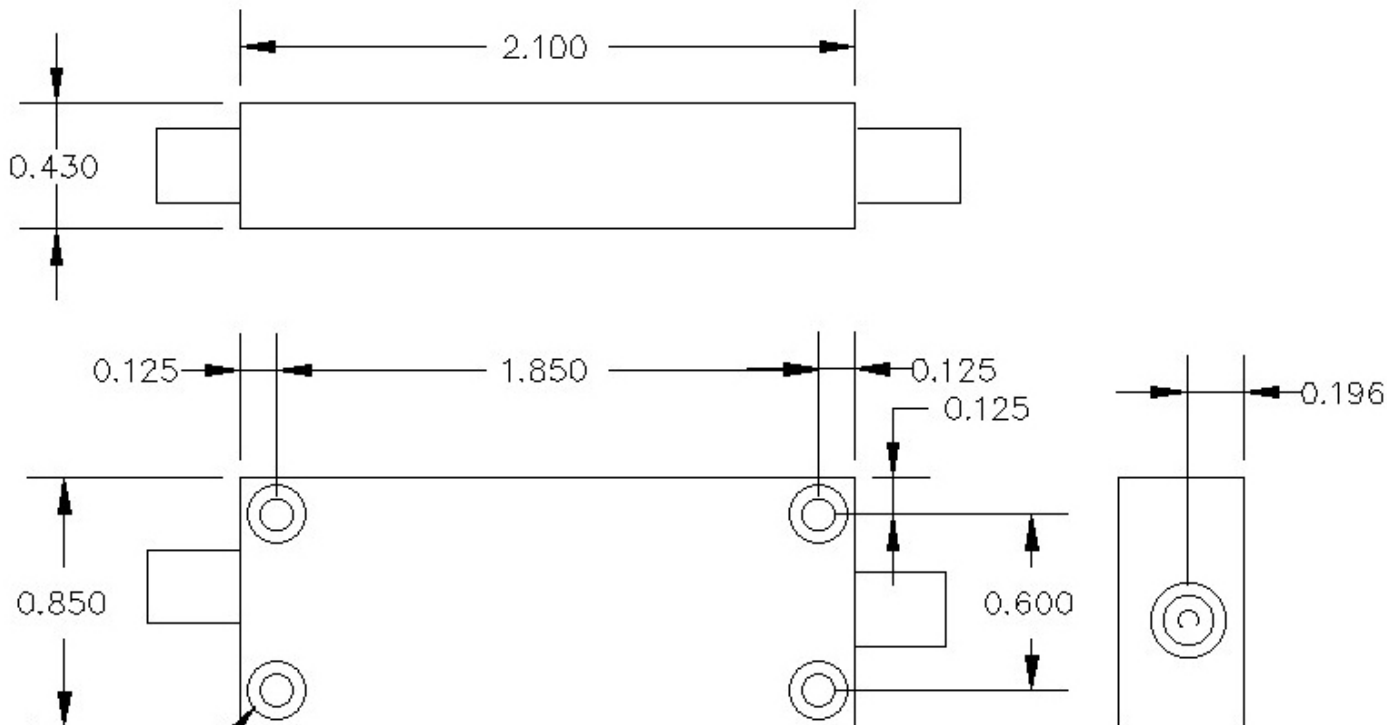

986991