



**ANATECH ELECTRONICS INC**  
RF & Microwave Filters & Products

# 800 MHz LC Bandpass Filter

**Part Number: AE800B6360**



## Electrical Specifications

**Center Frequency:** 800 MHz  
**Bandwidth:** 200 MHz  
**Passband Frequencies:** 700 MHz to 900 MHz  
**Insertion loss:** <3dB  
**VSWR:** <1.5:1  
**Impedance:** 50 Ohms  
**Rejection:** >50dB @ 0- 400 MHz  
**Rejection2:** >50dB @ 1100-1500 MHz  
**Rejection3:** >60dB @ 1200 MHz

## Mechanical

**Mounting Method :** Surface Mount  
**Connector Type:** RF Pins 0.020 input pins  
**Dimensions:** 1.5" X 0.5" x 0.4" in.

## Environmental

**Operating Temperature:** -25°C to +70°C  
**Storage Temperature:** -40°C to +90°C  
**Shock:** 10 G. 11ms  
**Vibration:** 10 G. 5 to 200Hz

## Outline Drawing:

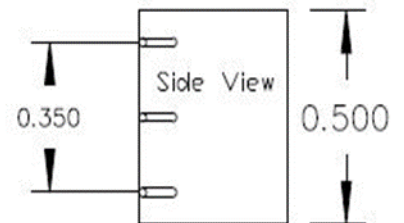
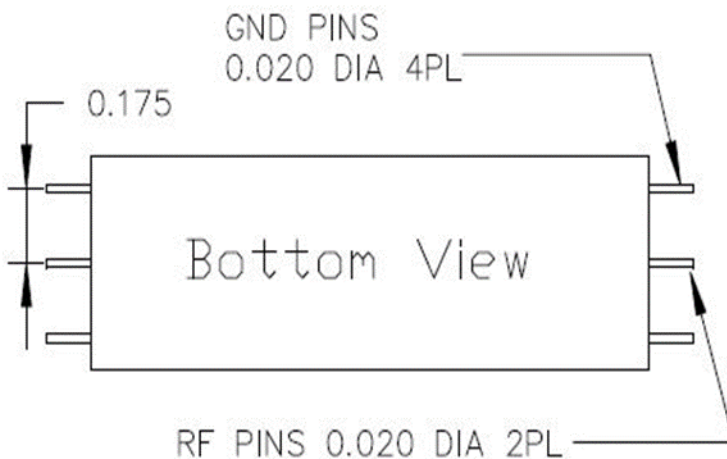
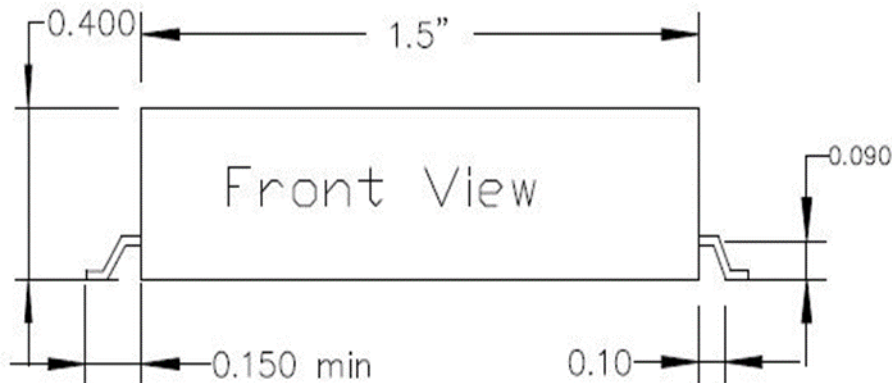



**Response Plot:**

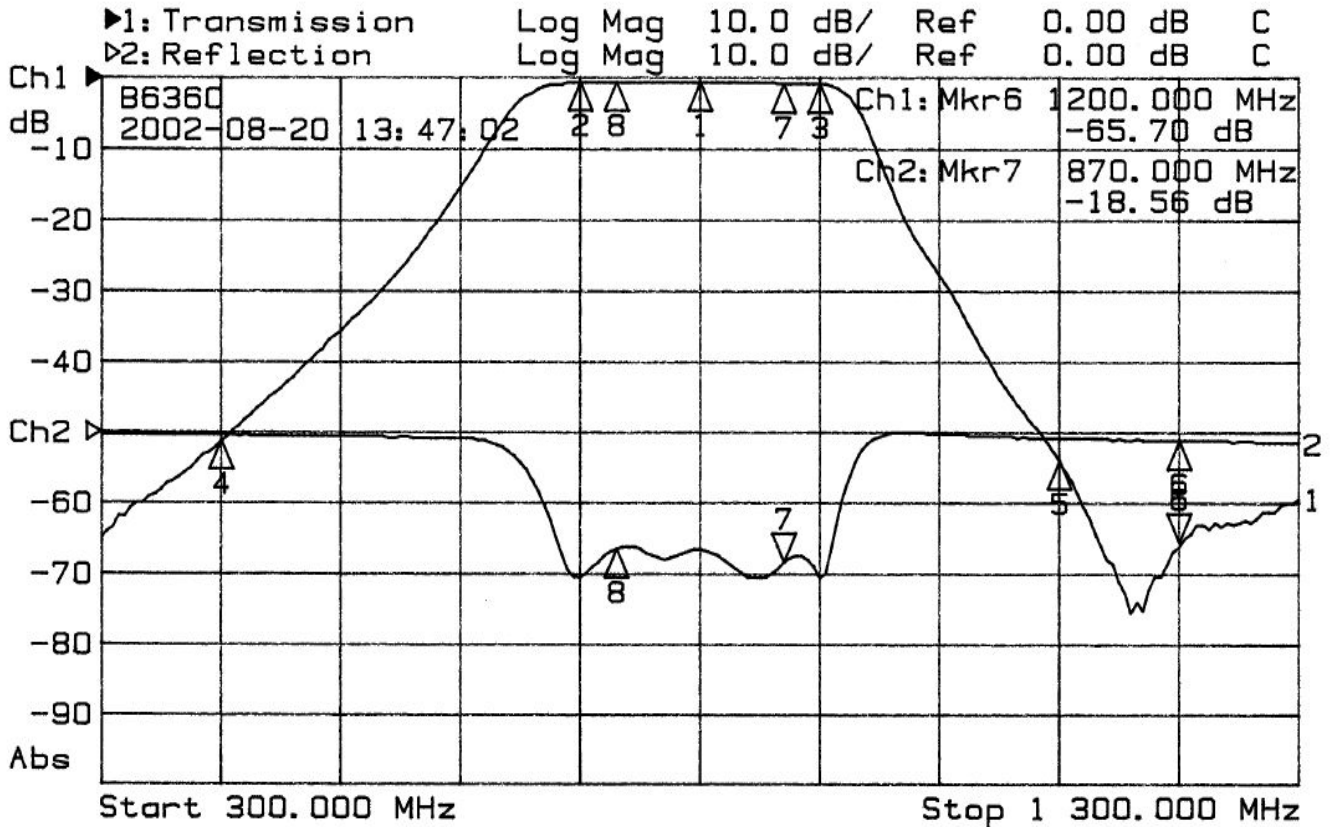

1: Mkr (MHz)	dB	2: Mkr (MHz)	dB
1: 800.00	-0.69		
2: 700.00	-0.72		
3: 900.00	-0.97		
4: 400.00	-51.31		
5: 1100.00	-54.07		
6> 1200.00	-65.70	6: 1200.00	-1.29
7: 870.00	-0.86	7> 870.00	-18.56
8: 730.00	-0.75	8: 730.00	-16.48