

Wire Range	Insulation Diameter	Reel Q'ty
AWG #24~#30	1.45 (.057) MAX.	10,000 PCS.

Ordering Code:

CI01 T01 1 P E 0
 ① ② ③ ④ ⑤ ⑥

① Series No.

② Type: T01= AWG #24~ #30

③ Plating: 1= 2.03μm(80μ") Min. Tin
 over 0.76μm(30μ") Nickel

④ Material: P= Phosphor Bronze

⑤ Plating method: E= Pre-tinned

⑥ Option: 0= Standard

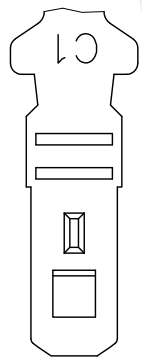

BACK VIEW

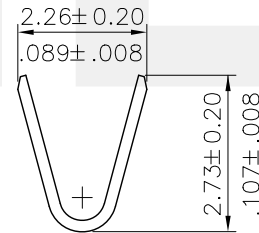
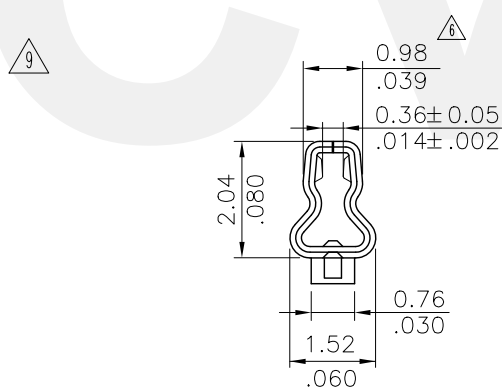

SEC.:A-A

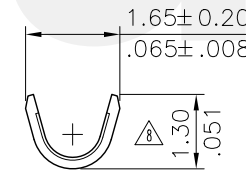

SEC.:B-B

RoHS Compliant

SYM	NAME	DATE	REVISIONS	APPROVED BY:	DATE	UNIT:	TITLE:	MATERIAL:	FINISH:	DRAWING NO.	CIO104SQ	PART NO.	CIO1T011PEO	
9	Erin	5/7-12'	ECR12021-0/ECN12074-0	CVILUX CORP		mm / inch	2.00MM(.079")							
8	Hank	5/10-11'	ECR11032-0	2012.05.28	5/15-12'	TOLERANCE UNLESS OTHERWISE SPECIFIED	CRIMP TERMINAL							
7	Sun	8/14-09'	ECR09090-1/ECN09414	ISSDUE	5/15-12'		.X ± 0.20/.008							
6	Sandy	1/20-09'	ECN09011		5/15-12'		.XX ± 0.10/.004							
					5/15-12'	.XXX ± 0.05/.002								
										SCALE	6 / 1	SHEET	1 OF 1	

瀚荃股份有限公司
 CviLux Corporation