

High Performance Power Line Filter for Medical Applications

AMI-M11F/11G/12O/12P Series



AMI Designation	Input/output Style				Current Rating	Inductance mH	Capacitance		Resistor K Ω	Leakage Current @ 120 VAC 60Hz/250 VAC 50 Hz	TIL Insertion Loss	Case Style
							Cx nF	Cy pF		μ A		
Available Part Numbers	0.250 Spade Terminals	Wire Leads	Threaded Bolts	IEC Socket Spade/Terminal								
AMI-M11F-1-3-A	1	-	-	-	3	36.8	940	0	330	2 μ A/5 μ A	001	A
AMI-M11F-1-6-A	1	-	-	-	6	18.5	940	0	330	2 μ A/5 μ A	002	A
AMI-M12O-1-10-A	1	-	-	-	10	9.5	1770	0	330	2 μ A/5 μ A	003	A
AMI-M12P-1-15-A	1	-	-	-	15	5.07	2072	0	330	2 μ A/5 μ A	004	B
AMI-M11F-3-3-A	-	3	-	-	3	36.8	940	0	330	2 μ A/5 μ A	001	C
AMI-M11F-3-6-A	-	3	-	-	6	18.5	940	0	330	2 μ A/5 μ A	002	C
AMI-M12O-3-10-A	-	3	-	-	10	9.5	1770	0	330	2 μ A/5 μ A	003	C
AMI-M11G-7-3-A	-	-	-	7	3	36.8	940	0	330	2 μ A/5 μ A	001	E
AMI-M11G-7-6-A	-	-	-	7	6	18.5	1089	0	330	2 μ A/5 μ A	002	E
AMI-M12P-6-15-A	-	-	6	-	15	5.07	2072	0	330	2 μ A/5 μ A	004	D
AMI-M11G-7M-3-A	-	-	-	7M	3	36.8	940	0	330	2 μ A/5 μ A	001	E
AMI-M11G-7M-6-A	-	-	-	7M	6	18.5	1089	0	330	2 μ A/5 μ A	002	E

Electrical Schematic

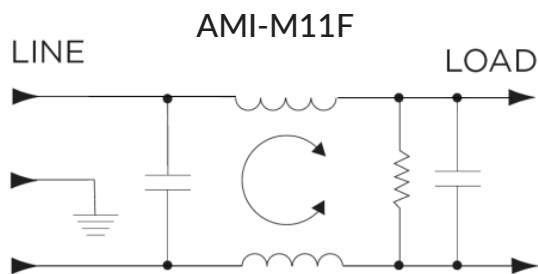

High Performance Power Line Filter for Medical Applications

Electrical Schematic

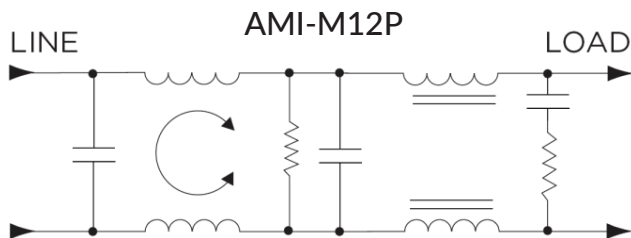
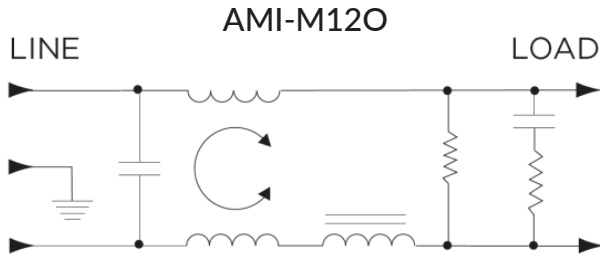
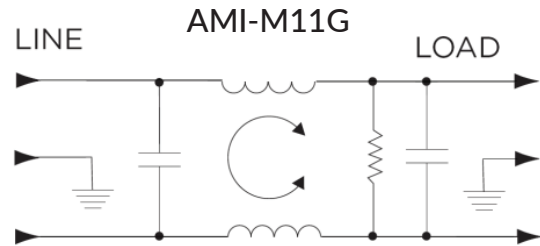

Specifications:

- Rated Voltage (max): 250 VAC
- Operating Frequency: 50/60 Hz
- Operating Current: 3 to 15 A
- Hi-pot Rating (one minute): Line to Ground: 2250 VDC
Line to Line: 1450 VDC
- Operating Ambient Temperature Range (at rated current I_r): -10°C to $+40^{\circ}\text{C}$. In an ambient temperature (T_a) higher than $+40^{\circ}\text{C}$ the maximum operating current (I_o) is calculated as follows: $I_o = I_r \sqrt{[(85 - T_a) / 45]}$

High Performance Power Line Filter for Medical Applications

Performance Data

Typical Insertion Loss

Measured in closed 50 Ohm system

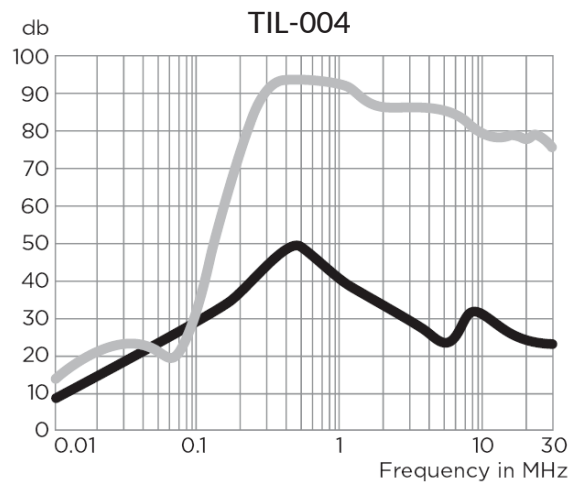
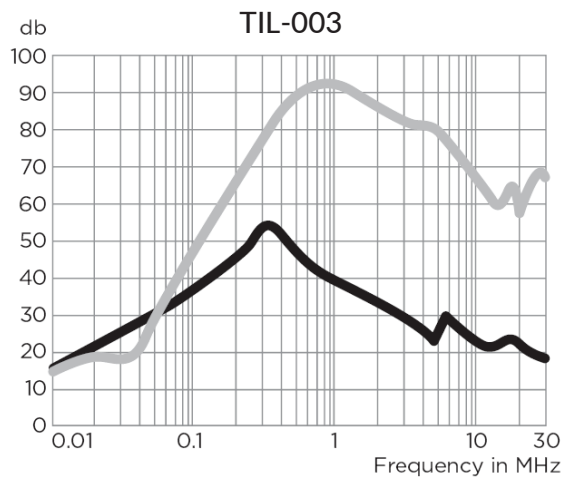
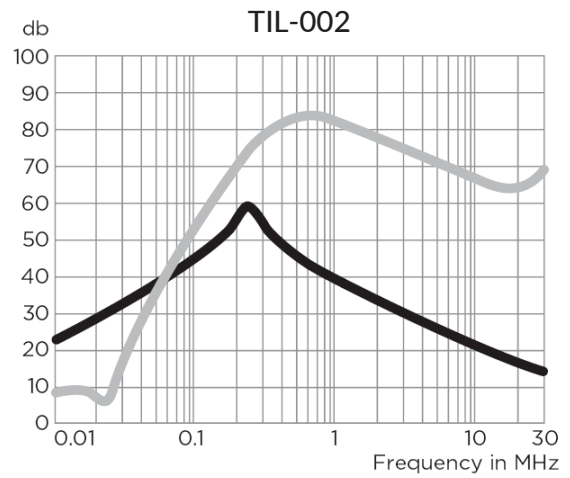
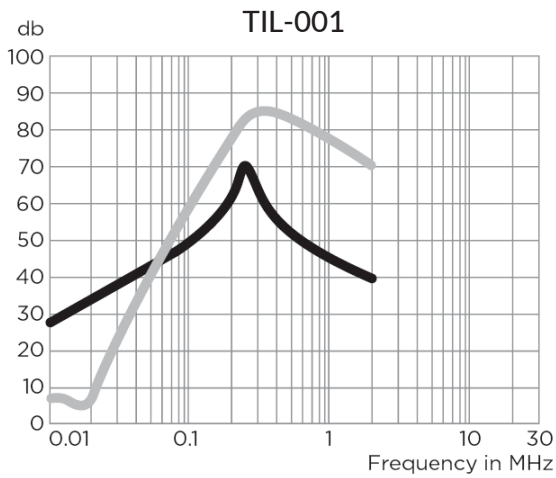

High Performance Power Line Filter for Medical Applications

Minimum Insertion Loss

Common Mode/Asymmetrical (Line to Ground)

Current Rating	Frequency-MHz									
Part Number	0.02	0.05	0.15	0.5	1	2	5	10	20	30
AMI-M11F/11G-X-3-A	22	36	49	46	40	30	22	12	12	12
AMI-M11F/11G-X-6-A	16	32	46	41	33	26	15	9	6	2
AMI-M12O-X-10-A	9	24	36	42	34	22	12	12	8	8
AMI-M12P-X-15-A	4	18	27	41	34	22	22	12	5	2

Differential Mode/Symmetrical (Line to Line)

Current Rating	Frequency-MHz									
Part Number	0.02	0.05	0.15	0.5	1	2	5	10	20	30
AMI-M11F/11G-X-3-A	3	30	61	70	65	65	48	40	32	32
AMI-M11F/11G-X-6-A	4	14	51	70	70	65	55	47	37	37
AMI-M12O-X-10-A	7	17	52	70	70	70	65	55	40	35
AMI-M12P-X-15-A	12	15	51	70	70	70	70	70	65	55

High Performance Power Line Filter for Medical Applications

Case Styles

STYLE A

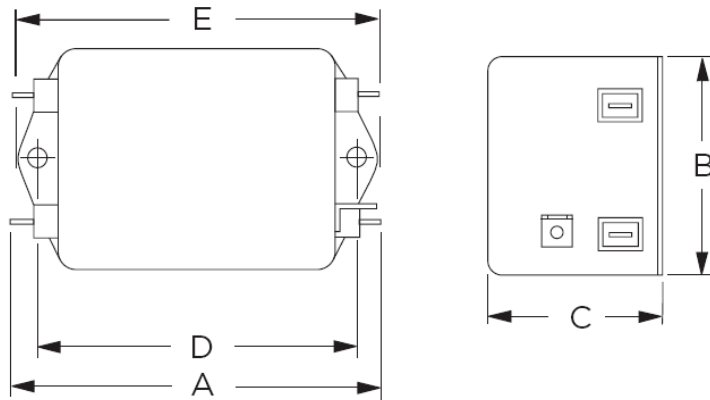

Typical Dimensions:

Line/Load Terminals (4):	.250 [6.3] with .07 [1.8] Dia. hole
Ground Terminal (1):	.250 [6.3] with .07 x .16 [1.8 x 3.8] slot
Mounting Holes (2):	.188 [4.78] Dia.

STYLE B

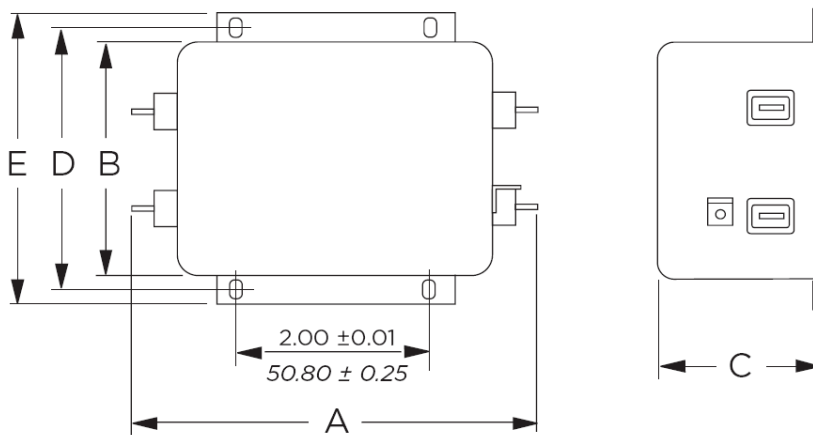

Typical Dimensions:

Line/Load Terminals (4):	.250 [6.3] with .07 [1.8] Dia. hole
Ground Terminal (1):	.250 [6.3] with .07 x .16 [1.8 x 3.8] slot
Mounting Slots (4):	.203 x .156 [5.16 x 3.96] Dia.

High Performance Power Line Filter for Medical Applications

Case Styles

STYLE C

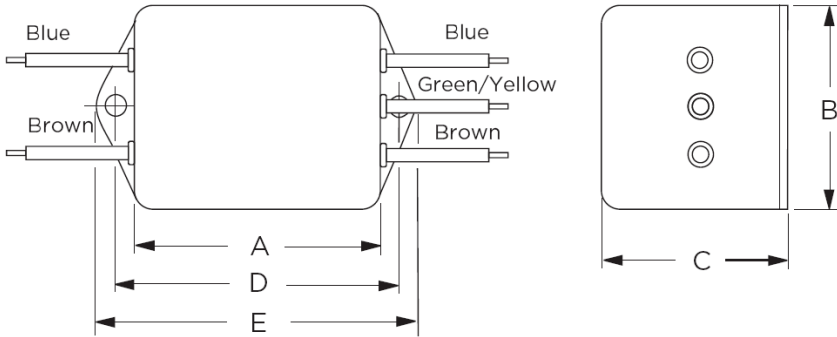

Typical Dimensions:

6A Wire Leads (5):	4.0 [101.6] Min., 18AWG
10A Wire Leads (5):	6.0 [152.4] Min., 18AWG
Mounting Holes (2):	.188 [4.78] Dia.

STYLE D

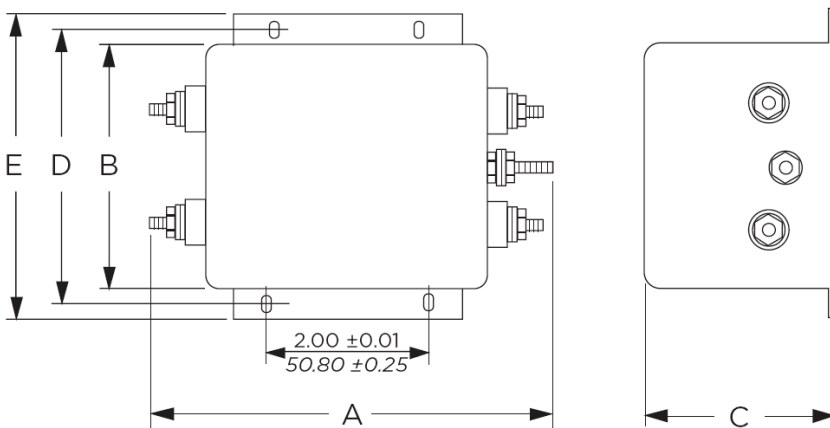

Typical Dimensions:

Terminals (5):	8-32, Torque 18 lbf-in. [2.03 N-m] max. ± 2 [.22]
Mounting Slots (4):	.203 x .156 [5.16 x 3.96] Dia.

High Performance Power Line Filter for Medical Applications

Case Styles

STYLE E

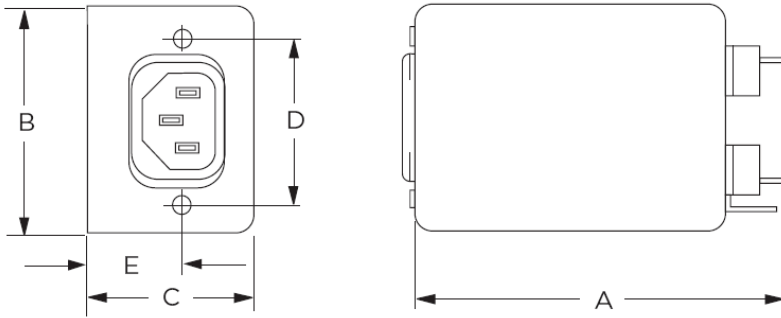

Typical Dimensions:

Load Terminals (2):	.250 [6.3] with .07 [1.8] Dia. hole
Ground Terminal (1):	.250 [6.3] with .07 x .16 [1.8 x 3.8] slot
Line Inlet (1):	IEC 60320-1 C14
7 Tapped Inserts (2):	6-32 x 1/4
7M Tapped Inserts (2):	M3 x .5

Recommended Panel Cutout

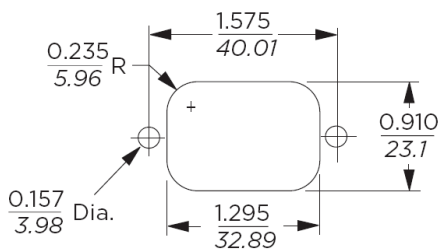

Tolerance $\pm .005$ [0.13]

High Performance Power Line Filter for Medical Applications

Case Dimensions:

Model Number	A max	B max	C max	D $\begin{smallmatrix} \pm .01 \\ \pm .25 \end{smallmatrix}$	E max
AMI-M11F-1-3/6-A	3.56"/90.4mm	2.15"/54.6mm	1.81"/46.0mm	2.938"/74.63mm	3.38"/85.9mm
AMI-M11F-3-3/6-A	2.55"/64.8mm	2.15"/54.6mm	1.81"/46.0mm	2.938"/74.63mm	2.78"/70.61mm
AMI-M11G-7/7M-3/6-A	3.52"/89.4mm	2.25"/57.2mm	1.78"/45.2mm	1.575"/40.01mm	*0.63/16.0mm
AMI-M12O-1-10-A	4.69"/119.1mm	2.27"/57.7mm	1.8"/45.7mm	4.063"/103.2mm	4.47"/113.5mm
AMI-M12O-3-10-A	3.69"/93.7mm	2.27"/57.7mm	1.8"/45.7mm	4.063"/103.2mm	4.47"/113.5mm
AMI-M12P-1-15-A	5.45"/138.4mm	3.12"/79.2mm	2.18"/55.4mm	3.5"/88.9mm	3.96/100.6mm
AMI-M12P-6-15-A	5.95"/151.1mm	3.12"/79.2mm	2.18"/55.4mm	3.5"/88.9mm	3.96/100.6mm

*±0.02/0.5