

## Base strip - DFK-MSTB 2,5/ 2-GF-5,08 - 0710170

Please be informed that the data shown in this PDF Document is generated from our Online Catalog. Please find the complete data in the user's documentation. Our General Terms of Use for Downloads are valid (<http://download.phoenixcontact.com>)



Plug component, Nominal current: 12 A, Rated voltage (III/2): 320 V, Number of positions: 2, Pitch: 5.08 mm, Connection method: Solder/Slip-on connection, Color: green, Contact surface: Tin, Assembly: Direct mounting

The figure shows a 10-position version of the product

### Product description

Plug component, Nominal current: 12 A, Rated voltage (III/2): 320 V, Number of positions: 2, Pitch: 5.08 mm, Connection method: Solder/Slip-on connection, Color: green, Contact surface: Tin, Assembly: Direct mounting

### Why buy this product

- Outside: plug-in connection for corresponding MSTB 2,5 or FKC 2,5 plugs
- Can be fixed in housing panels up to 6 mm thick using two M3 x 10 screws
- Headers for assembly in a device/housing panel
- Inside: solder or 2.8 mm slip-on plug-in connection that can be combined



### Key commercial data

|                                      |   |
|--------------------------------------|---|
| Packing unit                         | 1   |
| Minimum order quantity               | 50  |
| Catalog page                         | Page 325 (CC-2011)  |
| GTIN                                 | <br>4 017918 005207 |
| Weight per piece (including packing) | 0.0 GRM   |
| Weight per Piece (excluding packing) | 3.51 GRM  |
| Country of origin                    | GERMANY   |

### Technical data

#### Dimensions / positions

|                     |         |
|---------------------|---------|
| Pitch               | 5.08 mm |
| Dimension a         | 5.08 mm |
| Number of positions | 2       |

#### Technical data

|                           |                     |
|---------------------------|---------------------|
| Range of articles         | DFK-MSTB 2,5/...-GF |
| Insulating material group | I                   |

## Base strip - DFK-MSTB 2,5/ 2-GF-5,08 - 0710170

### Technical data

#### Technical data

|   |                     |
|---|---------------------|
| Rated surge voltage (III/3)             | 4 kV                |
| Rated surge voltage (III/2)             | 4 kV                |
| Rated surge voltage (II/2)              | 4 kV                |
| Rated voltage (III/2)                   | 320 V               |
| Rated voltage (II/2)                    | 630 V               |
| Connection in acc. with standard        | EN-VDE              |
| Nominal current I <sub>N</sub>          | 12 A                |
| Nominal voltage U <sub>N</sub>          | 320 V               |
| Nominal cross section                   | 2.5 mm <sup>2</sup> |
| Maximum load current                    | 12 A                |
| Insulating material                     | PA                  |
| Inflammability class according to UL 94 | V2                  |
| Nominal voltage, UL/CUL Use Group B     | 250 V               |
| Nominal current, UL/CUL Use Group B     | 12 A                |
| Nominal voltage, UL/CUL Use Group D     | 300 V               |
| Nominal current, UL/CUL Use Group D     | 10 A                |

#### Connection data

|  |                     |
|--|---------------------|
| Conductor cross section solid min.     | 0.2 mm <sup>2</sup> |
| Conductor cross section solid max.     | 2.5 mm <sup>2</sup> |
| Conductor cross section stranded min.  | 0.2 mm <sup>2</sup> |
| Conductor cross section stranded max.  | 2.5 mm <sup>2</sup> |
| Conductor cross section AWG/kcmil min. | 24                  |
| Conductor cross section AWG/kcmil max  | 12                  |

### Classifications

#### eclass

|            |          |
|------------|----------|
| eClass 4.0 | 272607xx |
| eClass 4.1 | 27260701 |
| eClass 5.0 | 27260701 |
| eClass 5.1 | 27141190 |
| eClass 6.0 | 27260704 |

#### etim

|          |          |
|----------|----------|
| ETIM 3.0 | EC001283 |
| ETIM 4.0 | EC001283 |

#### unspsc

|               |          |
|---------------|----------|
| UNSPSC 6.01   | 30211810 |
| UNSPSC 7.0901 | 39121409 |
| UNSPSC 11     | 39121409 |
| UNSPSC 12.01  | 39121409 |

# Base strip - DFK-MSTB 2,5/ 2-GF-5,08 - 0710170

## Classifications

unspsc

|             |          |
|-------------|----------|
| UNSPSC 13.2 | 39121409 |
|-------------|----------|

## Approvals

### Certificates

#### Certification

CSA / UL Recognized / VDE report with production monitoring / cUL Recognized / GOST / IEC CB Scheme / GOST / cULus Recognized

#### Certification EX

#### Certification submitted

## Approval details

| CSA                |       |       |
|--------------------|-------|-------|
|                    | B     | D     |
| Nominal current IN | 10 A  | 10 A  |
| Nominal voltage UN | 300 V | 300 V |

| UL Recognized      |       |       |
|--------------------|-------|-------|
|                    | B     | D     |
| Nominal current IN | 12 A  | 10 A  |
| Nominal voltage UN | 250 V | 300 V |

| VDE report with production monitoring |       |
|---------------------------------------|-------|
|                                       |       |
| Nominal current IN                    | 12 A  |
| Nominal voltage UN                    | 250 V |

| cUL Recognized     |       |       |
|--------------------|-------|-------|
|                    | B     | D     |
| Nominal current IN | 12 A  | 10 A  |
| Nominal voltage UN | 250 V | 300 V |

| GOST |
|------|
|------|

## Base strip - DFK-MSTB 2,5/ 2-GF-5,08 - 0710170

### Approvals

|                    |       |
|--------------------|-------|
| IECEE CB Scheme    |       |
|                    |       |
| Nominal current IN | 12 A  |
| Nominal voltage UN | 250 V |

|      |
|------|
| GOST |
|------|

|                  |
|------------------|
| cULus Recognized |
|------------------|

### Accessories

#### Accessories

#### Assembly

#### Screw set - DFK-MSTB-SS - 0708263

Screw set, for securing the header to the device wall, consists of an M3 x 10 screw, with a spring washer and a nut



#### Accessories - MSTB-BL - 1755477

Keying cap, for forming sections, plugs onto header pin, green insulating material



#### Plug/Adapter

#### Keying star - CR-MSTB - 1734401

Coding section, inserted into the recess in the header or the inverted plug, red insulating material



#### Additional products

## Base strip - DFK-MSTB 2,5/ 2-GF-5,08 - 0710170

### Accessories

Printed-circuit board connector - QC 1/ 2-STF-5,08 - 1883352

Plug component, Nominal current: 10 A, Rated voltage (III/2): 630 V, Number of positions: 2, Pitch: 5.08 mm, Connection me



Printed-circuit board connector - MSTBT 2,5/ 2-STF-5,08 - 1805301

Plug component, Nominal current: 12 A, Rated voltage (III/2): 320 V, Number of positions: 2, Pitch: 5.08 mm, Connection me



Printed-circuit board connector - FKCVW 2,5/ 2-STF-5,08 - 1873809

Plug component, Nominal current: 12 A, Rated voltage (III/2): 320 V, Number of positions: 2, Pitch: 5.08 mm, Connection me



Printed-circuit board connector - MVSTBR 2,5/ 2-STF-5,08 - 1835096

Plug component, Nominal current: 12 A, Rated voltage (III/2): 320 V, Number of positions: 2, Pitch: 5.08 mm, Connection me



Printed-circuit board connector - MVSTBW 2,5/ 2-STF-5,08 - 1834903

Plug component, Nominal current: 12 A, Rated voltage (III/2): 320 V, Number of positions: 2, Pitch: 5.08 mm, Connection me



Printed-circuit board connector - MSTBC 2,5/ 2-STZF-5,08 - 1809734

Plug component, Nominal current: 12 A, Rated voltage (III/2): 320 V, Number of positions: 2, Pitch: 5.08 mm, Connection me



## Base strip - DFK-MSTB 2,5/ 2-GF-5,08 - 0710170

### Accessories

---

Printed-circuit board connector - MSTB 2,5/ 2-STF-5,08 - 1777989

Plug component, Nominal current: 12 A, Rated voltage (III/2): 320 V, Number of positions: 2, Pitch: 5.08 mm, Connection me



Printed-circuit board connector - FKC 2,5/ 2-STF-5,08 - 1873207

Plug component, Nominal current: 12 A, Rated voltage (III/2): 320 V, Number of positions: 2, Pitch: 5.08 mm, Connection me



Printed-circuit board connector - FKCT 2,5/ 2-STF-5,08 - 1902301

Plug component, Nominal current: 12 A, Rated voltage (III/2): 320 V, Number of positions: 2, Pitch: 5.08 mm, Connection me



Printed-circuit board connector - FRONT-MSTB 2,5/ 2-STF-5,08 - 1777808

Plug component, Nominal current: 12 A, Rated voltage (III/2): 320 V, Number of positions: 2, Pitch: 5.08 mm, Connection me



Printed-circuit board connector - FKCVR 2,5/ 2-STF-5,08 - 1874109

Plug component, Nominal current: 12 A, Rated voltage (III/2): 320 V, Number of positions: 2, Pitch: 5.08 mm, Connection me

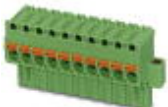

# Base strip - DFK-MSTB 2,5/ 2-GF-5,08 - 0710170

## Accessories

Printed-circuit board connector - TMSTBP 2,5/ 2-STF-5,08 - 1853104

Plug component, Nominal current: 12 A, Rated voltage (III/2): 320 V, Number of positions: 2, Pitch: 5.08 mm, Connection me



## Drawings

Drilling diagram

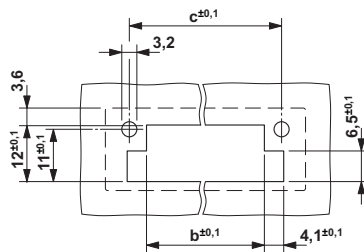

Dimensioned drawing

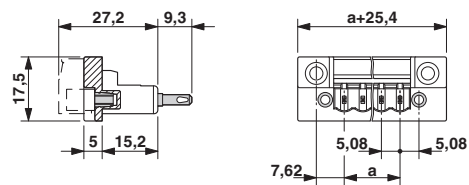

Dimension b: 3.02 mm + (no. of pos. x 5.08 mm)  
Dimension c: Dim. b + 7.14 mm