

## Base strip - DFK-IPCV 16/ 4-G-10,16 - 1703072

Please be informed that the data shown in this PDF Document is generated from our Online Catalog. Please find the complete data in the user's documentation. Our General Terms of Use for Downloads are valid (<http://download.phoenixcontact.com>)

Header, Nominal current: 76 A, Rated voltage (III/2): 1000 V, Number of positions: 4, Pitch: 10.16 mm, Color: green, Contact surface: Silver, Assembly: Soldering

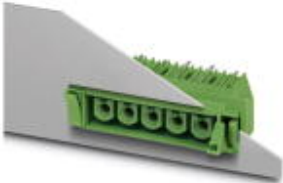

The figure shows a 5-pos. version of the product

### Product Features

- Panel thickness of 1 mm to 3 mm
- Inverted feed-through headers for implementing a touch-proof PCB output (in combination with IPC 16 ST)
- Tool-free snap-lock mechanism or conventional screw connection
- For soldering onto the PCB



### Key commercial data

|                                      |           |
|--------------------------------------|-----------|
| Packing unit                         | 1 pc      |
| Minimum order quantity               | 10 pc     |
| Weight per Piece (excluding packing) | 24.25 GRM |
| Custom tariff number                 | 85366990  |
| Country of origin                    | Germany   |

### Technical data

#### Dimensions

|                |           |
|----------------|-----------|
| Length         | 22 mm     |
| Height         | 34.55 mm  |
| Pitch          | 10.16 mm  |
| Dimension a    | 30.48 mm  |
| Pin dimensions | 0,8 x 1,2 |
| Pin spacing    | 10.16 mm  |
| Hole diameter  | 1.7 mm    |

#### General

## Base strip - DFK-IPCV 16/ 4-G-10,16 - 1703072

### Technical data

#### General

|   |                  |
|---|------------------|
| Range of articles                       | DFK-IPCV 16/..-G |
| Insulating material group               | I                |
| Rated surge voltage (III/3)             | 8 kV             |
| Rated surge voltage (III/2)             | 8 kV             |
| Rated surge voltage (II/2)              | 6 kV             |
| Rated voltage (III/3)                   | 1000 V           |
| Rated voltage (III/2)                   | 1000 V           |
| Rated voltage (II/2)                    | 1000 V           |
| Connection in acc. with standard        | EN-VDE           |
| Nominal current $I_N$                   | 76 A             |
| Maximum load current                    | 76 A             |
| Insulating material                     | PA               |
| Inflammability class according to UL 94 | V0               |
| Color                                   | green            |
| Number of positions                     | 4                |

### Classifications

#### eCl@ss

|            |          |
|------------|----------|
| eCl@ss 4.0 | 272607xx |
| eCl@ss 4.1 | 27260701 |
| eCl@ss 5.0 | 27260701 |
| eCl@ss 5.1 | 27141190 |
| eCl@ss 6.0 | 27260704 |
| eCl@ss 7.0 | 27440402 |
| eCl@ss 8.0 | 27440402 |

#### ETIM

|          |          |
|----------|----------|
| ETIM 3.0 | EC001121 |
| ETIM 4.0 | EC002637 |
| ETIM 5.0 | EC002637 |

#### UNSPSC

|               |          |
|---------------|----------|
| UNSPSC 6.01   | 30211810 |
| UNSPSC 7.0901 | 39121409 |
| UNSPSC 11     | 39121409 |
| UNSPSC 12.01  | 39121409 |
| UNSPSC 13.2   | 39121409 |

# Base strip - DFK-IPCV 16/ 4-G-10,16 - 1703072

## Drawings

Drilling diagram

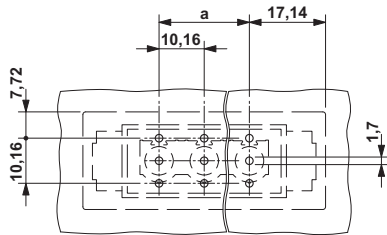

Diagram



The illustration shows the derating curve for DFK-IPC 16/...-G-10,16 inverted plugs in combination with the inverted header IPC 16/...-ST-10,16.

Dimensioned drawing

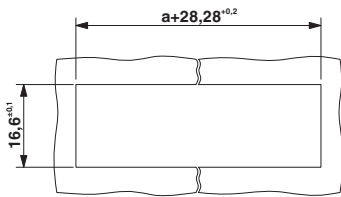

Sheet metal cutout for snap-on.

Dimensioned drawing

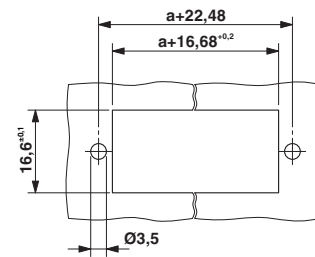

Sheet metal cutout for screw connection.

Dimensioned drawing

