

SHIELD ASSEMBLED ONTO HOUSING

NOTES:

- 1- MATERIAL:
 PLUG HOUSING:
 CLEAR POLYCARBONATE UL94 V0
 WIRE-MANAGER:
 CLEAR POLYCARBONATE UL94 V0
 TERMINALS:
 PHOSPHOR BRONZE PLATED WITH 0.00127/.00005 MIN. GOLD
 IN CONTACT AREA, 0.00127/.00005 MIN. THIN LEAD IN PIERCE
 AREA BOTH OVER 0.00127/.00005 MIN. NICKEL
 SHIELD:
 COPPER ALLOY PLATED WITH 0.00254/.000100 MIN.
 BRIGHT TIN OVER 0.00127/.00005 MIN. NICKEL
- 2- PRODUCT INTENDED TO TERMINATE
 ROUND SHIELDED PIMF CABLE
 WITH JACKET O.D.: 5.9 +0.2 -0.3/ .232 +0.08 -.012
 AS PER APPLICATION SPECIFICATION
 APPLICATION TOOLING- HAND TOOL:69008-1192
 DIE SET:69008-1193
- 3- PRODUCT SPECIFICATION: PS-85568-001
- 4- APPLICATION SPECIFICATION: AS-85568-002
- 5- PACKAGING SPECIFICATION: PK-85568-001
- 6- MATING INTERFACE DIMENSIONS OF PLUG ACC.
 IEC 60603-7-1 FREE CONNECTOR-VARIANT 02

APP TOOLING ADDED TO NOTE 6 EC NO: E2007-0831 DRW/NP/GRADY 2007/03/23 CH/KD: 2007/03/23 APPR: EOMAHONY 2007/03/23	QUALITY SYMBOLS	GENERAL TOLERANCES (UNLESS SPECIFIED)		DIMENSION STYLE MM/IN		SCALE 5:1	DESIGN UNITS METRIC	THIRD ANGLE PROJECTION		
	▽=0 ∇=0	4 PLACES ± --- ± --- 3 PLACES ± --- ± --- 2 PLACES ± 0.25 ± .010 1 PLACE ± --- ± --- ANGULAR ± .5 °	mm INCH ± --- ± --- ± --- ± --- ± --- ± --- ± --- ± ---	DRAWN BY SSTEINKE CHECKED BY SFILIPON APPROVED BY MHEIM	DATE 2002/10/01 DATE 2002/10/08 DATE 2002/10/08	TITLE SHIELDED MOD. PLUG CAT.6 8 POS. WITH WIRE MANAGER ROUND CABLE		MOLEX INCORPORATED		
	DRAFT WHERE APPLICABLE MUST REMAIN WITHIN DIMENSIONS	MATERIAL NO. SEE SHEET 2		DOCUMENT NO. SD-85568-001		SHEET NO. 1 OF 2		THIS DRAWING CONTAINS INFORMATION THAT IS PROPRIETARY TO MOLEX INCORPORATED AND SHOULD NOT BE USED WITHOUT WRITTEN PERMISSION		
	REV									

10 9 8 7 6 5 4 3 2 1

ASSEMBLY HOUSING

WIRE MANAGER

SHIELD

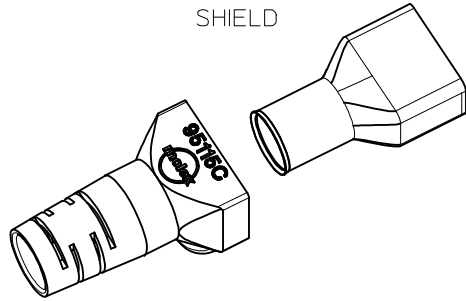

BOOT WITH LATCH PROTECTION
(IF REQUESTED)

SHIELDED PLUG COMPOSITION

ASSEMBLY PART NUMBER	BOOT WITH LATCH PROTECTION			PARTS/ UNIT	PACKAGING VERSION
	PART NUMBER	COLOR	RAL NBR		
85568-7880	NO BOOT			1	A
85568-7881	95115-4881	BLACK	9005	1	A
85568-7882	95115-4882	GREY	7012	1	A
85568-7883	95115-4883	GREEN	6016	1	A
85568-7884	95115-4884	RED	3000	1	A
85568-7885	95115-4885	YELLOW	1021	1	A
85568-7886	95115-4886	BLUE	5015	1	A
85568-7887	95115-4887	ORANGE	2004	1	A

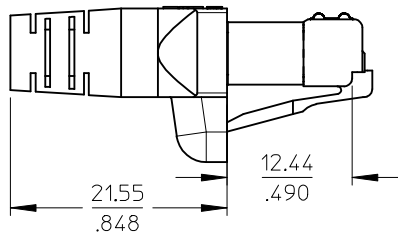

EC NO: E2007-0831 DRW: PGRADY 2007/03/23 CHKD: 2007/03/23 APPR: EOMAHONY 2007/03/23 REV	QUALITY SYMBOLS	GENERAL TOLERANCES (UNLESS SPECIFIED)	DIMENSION STYLE	SCALE	DESIGN UNITS	THIRD ANGLE PROJECTION
	▼=0 ◻=0	4 PLACES ± --- ± --- 3 PLACES ± --- ± --- 2 PLACES ± 0.25 ± .010 1 PLACE ± --- ± --- ANGULAR ± .5 °	MM/IN	2:1	METRIC	
		DRAWN BY: SSTEINKE CHECKED BY: SFILIPON APPROVED BY: MHEIM DATE: 2002/10/01 DATE: 2002/10/08 DATE: 2002/10/08	TITLE	SHIELDED MOD. PLUG CAT.6 8 POS. WITH WIRE MANAGER ROUND CABLE		
		DRAFT WHERE APPLICABLE MUST REMAIN WITHIN DIMENSIONS	MATERIAL NO. SEE CHART	MOLEX INCORPORATED DOCUMENT NO. SD-85568-001	SHEET NO. 2 OF 2	

9 8 7 6 5 4 3 2 1