

| PANDUIT PART NUMBER | CONDUCTOR SIZE | STUD SIZE | OVERALL LENGTH "A" +/- .12 | BARREL LENGTH "B" MIN | BARREL | | TONGUE WIDTH "W" +/- .060 | TONGUE THICKNESS "T" +/- .020 | TONGUE LENGTH "P" MIN | HOLE OFFSET "G" +/- .031 | STUD HOLE DIA "D" +/- .02 | WRENCH CLEARANCE "C" REF | WIRE STRIP LENGTH | PANDUIT DIE COLOR CODE PANDUIT DIE INDEX NUMBER (BURNDY DIE INDEX NUMBER) |
|----------------------------|----------------|--------------|----------------------------|-----------------------|---------------|---------------|---------------------------|-------------------------------|-----------------------|--------------------------|---------------------------|--------------------------|-------------------|---|
| | | | | | I.D. +/- .010 | O.D. +/- .010 | | | | | | | | |
| LAA300-38-2 LAA300-12-2 | 300 kcmil | 3/8" 1/2" | 4.00 | 2.25 | 0.65 | 1.01 | 1.38 | 0.34 | 1.31 | 0.63 | 0.41 0.53 | 0.68 | 2-5/16" | BLUE DIE P76 (470) |
| LAA350-12-2 | 350 kcmil | 1/2" | 4.28 | 2.25 | 0.72 | 1.11 | 1.51 | 0.38 | 1.31 | 0.63 | 0.53 | 0.68 | 2-5/16" | BROWN DIE P87 (299) |
| LAA400-58-2R | 400 kcmil | 5/8" | 4.88 | 2.50 | 0.76 | 1.19 | 1.61 | 0.41 | 1.25 | 0.63 | 0.66 | 0.62 | 2-9/16" | GREEN DIE P94 (472) |
| LAA500-12-2 LAA500-58-2 | 500 kcmil | 1/2" 5/8" | 5.50 | 3.00 | 0.84 | 1.32 | 1.74 | 0.45 | 1.50 | 0.63 | 0.53 0.66 | 0.87 | 3-1/16" | PINK DIE P99 (300) |
| LAA750-12-1 LAA750-58-1 | 750 kcmil | 1/2" 5/8" | 6.50 | 3.38 | 1.03 | 1.59 | 1.74 | 0.54 | 1.88 | 0.88 | 0.53 0.66 | 1.00 | 3-7/16" | RED DIE P125 (301) |
| LAA1000-58-1 | 1000 kcmil | 5/8" | 7.31 | 4.50 | 1.19 | 1.84 | 2.56 | 0.63 | 1.88 | 0.88 | 0.66 | 1.00 | 4-3/4" | BROWN DIE P161 (302) |

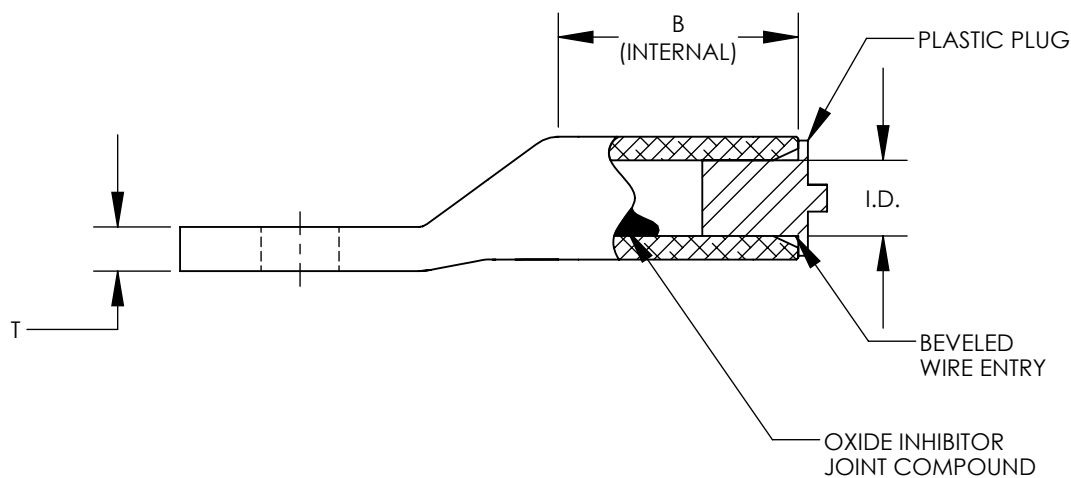

NOTES:

1. MATERIAL: SEAMLESS ALUMINUM TUBING, TIN PLATED
2. BARREL COLOR CODED WITH DIE SET INDEX NUMBER
3. FOR STRANDED ALUMINUM AND COPPER WIRE
4. UL LISTED & CSA CERTIFIED TEMPERATURE RATED 90° C (AL9CU)
5. UL LISTED & CSA CERTIFIED VOLTAGE RATING 35 KV
6. ALL DIMENSIONS IN INCHES

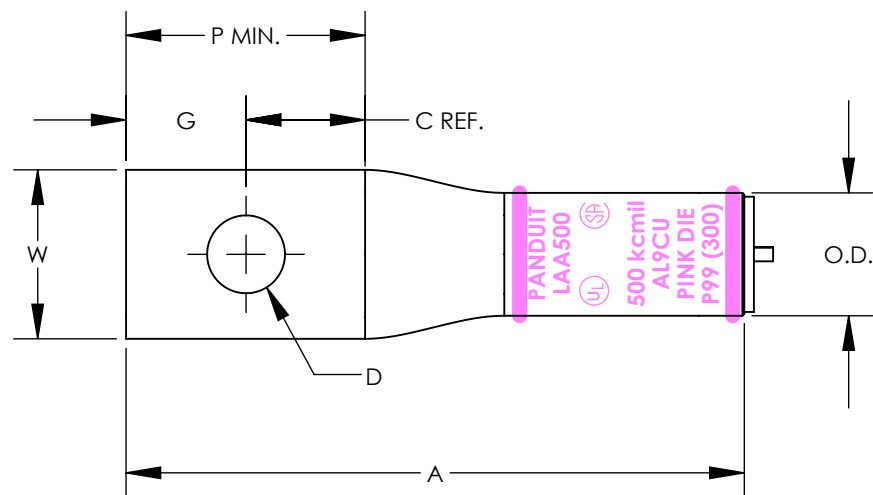

| REV | DATE | BY | CHK | APR | DESCRIPTION | ECN |
|-----|------|------|------|-----|---|-----------------|
| 10 | 7/16 | JHNU | JHNU | RGB | REVISED OVERALL LENGTH FOR LAA400-58-2R: 4.88 WAS 4.68 | N41129BB-C41129 |
| 09 | 5/16 | JHNU | JHNU | RGB | ADDED NOTE TO SPECIFY LAA750-12-1 IS cULus | N41129BB-C41129 |
| 08 | 8/15 | JHNU | JHNU | RGB | ADDED "D" DIMENSION | N41129BB-C41129 |
| 07 | 3/15 | JHNU | JHNU | RGB | REVISED A DIMENSION: LAA400-58-2R WAS 4.88 | N41129BB-C41129 |
| 06 | 3/15 | JHNU | JHNU | RGB | REVISED DIMENSIONS, REVISED NOTES ADDED BARREL MARKING ADDED COLOR CODE/DIE INDEX NUMBER REMOVED LAA400-58-2, ADDED LAA400-58-2R | N41129BB-C41129 |
| 05 | 3/13 | JHNU | JHNU | RGB | REVISED TITLE BLOCK CONVERTED TO SOLIDWORKS | N41129BB-C41129 |

| | | | |
|--|--------------------|---|------------|
| TITLE | | LAA SERIES 300kcmil-1000kcmil ALUMINUM LUGS CUSTOMER DRAWING | |
| ITEM REVISION NAME | N41129BB-C41129/10 | | |
| DATASET FILE NAME | C41129/10.SLDDRW | | |
| UNLESS OTHERWISE SPECIFIED, DIMENSIONAL TOLERANCES ARE: IN [mm] | | MATERIAL | |
| .X ± | .XXX ± | SEE NOTES | |
| .XX ± | ANGLES ± | | |
| DRAWN BY WL | | DATE 2/93 | CHK GRM |
| SCALE NONE | | DRAWING NUMBER C41129 | |
| SHEET 1 OF 1 | | SIZE B | |