

Electrical Testing  
per Tusonix standard  
test plans and Mil-Std-202  
Test Methods.

**MARKETING SALES DRAWING**  
**DIMENSIONS IN INCHES - DO NOT SCALE THIS DRAWING**  
**DIMENSIONS IN METRIC - [ ]**

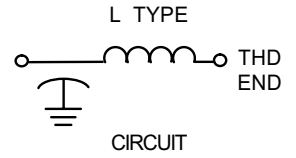
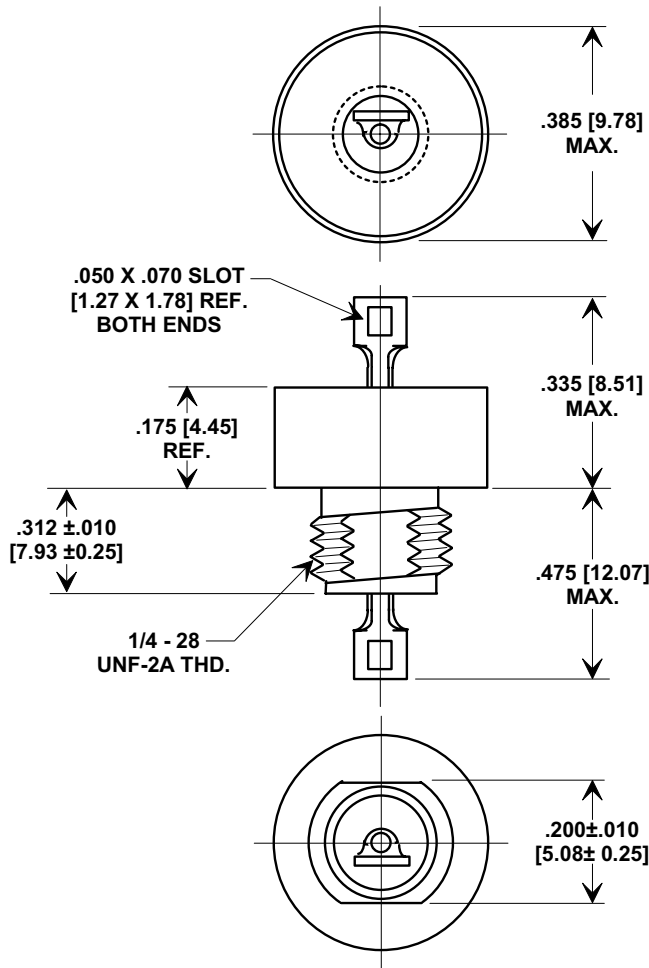
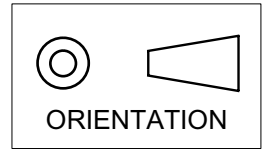

**NOTES:**

**MATERIALS:**

- BUSHING - TIN PLATED STEEL**
- LEAD - SOLDER PLATED COPPER**
- NUT - TIN PLATED BRASS**
- L"WASHER - TIN PLATED PHOSPHOR BRONZE**

**MOUNTING TORQUE: 8 lb - ins. max**

**DCR - .01Ω max.**

**MAX. SOLDER TEMPERATURE 500°F**

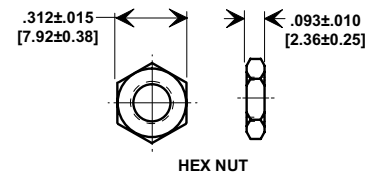
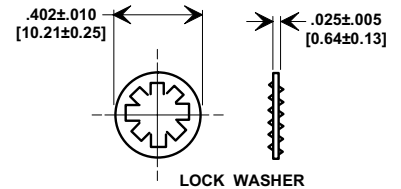

MIN. CAP (UF)	DWV (VDC)	I.R. MIN. @ 100 (VDC.)	WORKING VOLTAGE D.C.		CURRENT DC (AMPS).	MIN. NO LOAD INSERTION LOSS (dB) @ 25°C PER MIL-STD-220					
			85°C	125°C		30 KHz	100 KHz	300 KHz	1 MHz	10 MHz	1 GHz
1.4	250	500 M	100	50	15	15	25	34	44	60	70

<b>REVISION RECORD</b>	0	Original Release C.O.	TABLE REVISED 50 WVDC @ 125° WAS 70 WVDC @ 125° L.E. 01-17-03	5	ADDED IR & DWV. SM 03-06-03	<p>--TOLERANCES-- Unless Otherwise Specified</p> <p>DECIMAL ± </p> <p>ANGLES ± </p> <p><b>TUSONIX</b> TUCSON, ARIZONA</p>	Title <b>COAXIAL BROADBAND - "L" HERMETICALLY SEALED</b>	
	1	RDN TO COMP FMP. STYLE DWG SPLIT FOR EACH VAR. S.M. 06-20-02		6			Drawn S.M. 06-20-02	Scale 3 X
	2	2002		7			20030106-1-14	Approved J.Mc. 06-20-02
	3	20030304-2-14		A			4601-054	