

# MARKETING SALES DRAWING

**DIMENSIONS IN INCHES - DO NOT SCALE THIS DRAWING**  
**DIMENSIONS IN METRIC - [ ]**

This drawing is the property of Tusonix, Inc., and may not be used, reproduced, published or disclosed to others without expressed authorization by Tusonix Inc.

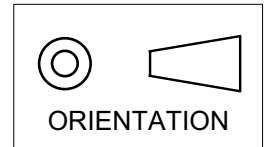

**Electrical Testing**  
per Tusonix standard  
test plans and Mil-Std-202  
Test Methods.

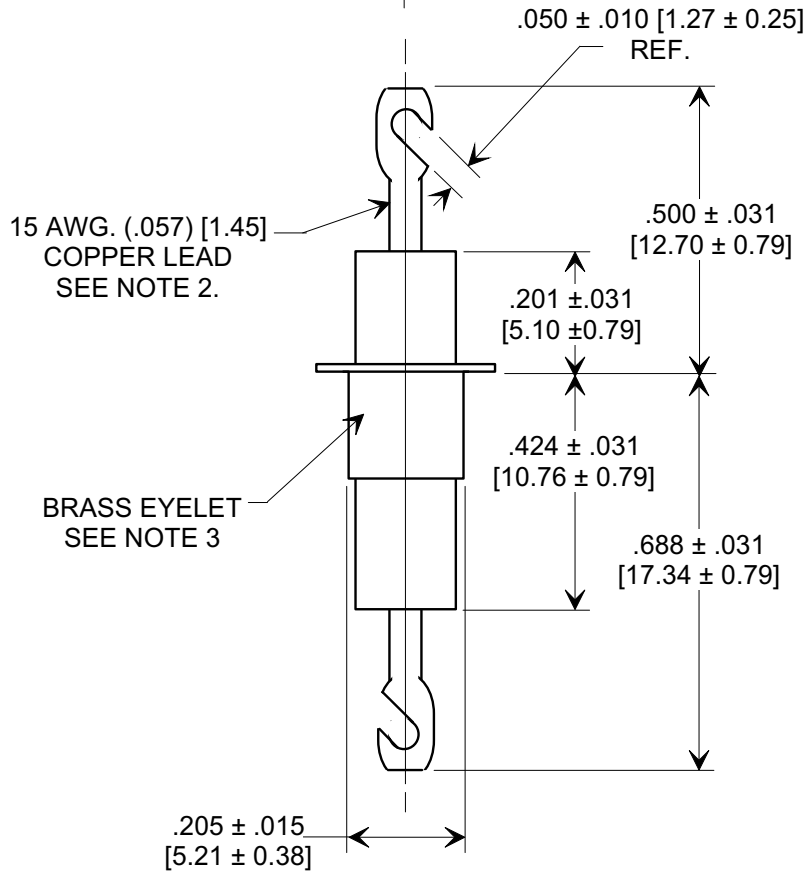
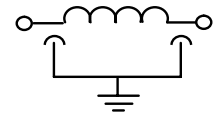
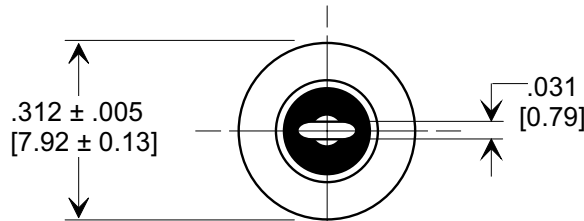

**NOTES:**

- TUSONIX STANDARD PART NUMBER: 4106-002.  
TUSONIX RoHS COMPLIANT PART NUMBER: 4106-002 LF.  
CUSTOMER MUST SPECIFY STANDARD OR RoHS PART NUMBER WHEN ORDERING.
- LEAD FINISH: STANDARD PART #: 60/40 SOLDER PLATED. RoHS PART #: SILVER PLATED.
- EYELET FINISH: STANDARD PART #: 60/40 SOLDER PLATED. RoHS PART #: SILVER PLATED.
- PART MARKING: STANDARD PART: NO MARKING. RoHS PART: GREEN DOT IDENTIFIER.

MIN. CAP (pF)	WORKING VOLTAGE (WVDC)		CURRENT Idc	I.R. MIN. @ 100 (VDC)	DWV	MINIMUM NO-LOAD INSERTION LOSS			
	85°C	125°C				10 MHz	100 MHz	1 GHz	10 GHz
3000	1000	500	25A	10 G Ω	1500 VDC	5	50	65	65

<b>REVISION RECORD</b> Original Release C.O. 20031118-1-01 ADDED NOTES 1-4. S.M. 01-08-07 20070102-1-04	0	1	--TOLERANCES-- Unless Otherwise Specified	Title <b>EYELET STYLE EMI FILTER</b>	
	DECIMAL ± .031 [ .79]				
	ANGLES ±		Drawn L.E. 11-18-03	Scale 3 X	
	<b>TUSONIX</b> TUCSON, ARIZONA		Approved T.C. 11-18-03		
			<b>A</b>	<b>4106-002</b>	

X-2015 Rev-0