

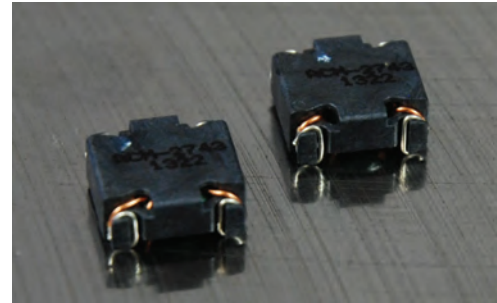

COMMON MODE CHOKE

ACM-2743



- SMD Package
- Operating Temp Range: 40°C to +125°C
- Test Condition Temperature at 25°C
- Humidity at 65 +/-5% RH

Electrical Specifications @25°C			
TEST ITEM	TEST CONDITION	RESULT	IDC
Inductance	@ 1KHz, 0.25V by 1062A	L1 (1 - 2)=L1 (3 - 4)=383uH±30% /-35%	3.3A MAX
DC Resistance	@ 25°C by CH-502	R1 (1 - 2) =R (3 - 4) : 18mΩ MAX	

MECHANICALS

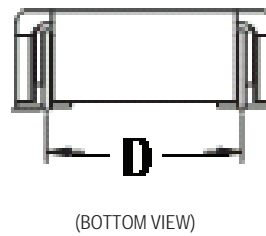
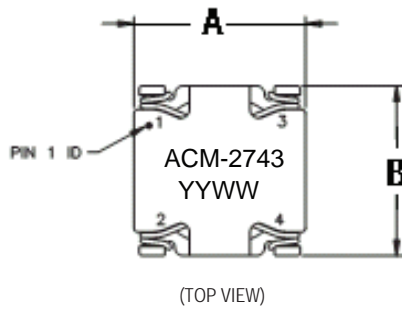

DIMENSIONS - MM

A	13.0 REF
B	13.0 REF
C	8.4 REF
D	10.4 REF
E	6.0 MAX

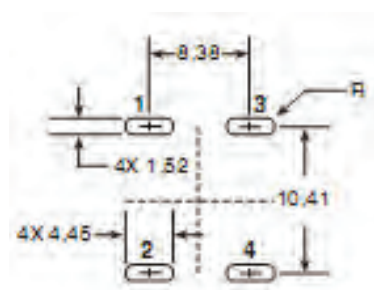
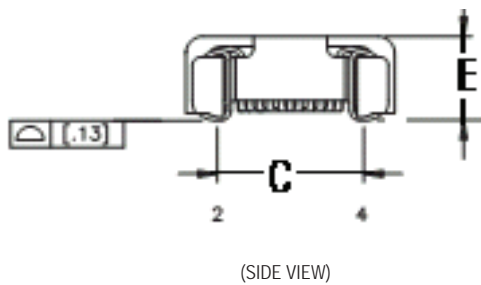

SCHEMATIC

