



DC-26.5 GHz

SMA and 3.5 mm Coaxial Fixed Terminations

- Low VSWR
- Operation to 26.5 GHz
- 10W, 5W and .5W models

Specifications

SMA (M), DC to 18 GHz (Low / Medium Power)

| FREQUENCY RANGE (GHz) | MODEL | POWER | | VSWR* (max.) | WEIGHT | |
|-----------------------|--------|-------------|-----------|--------------|--------|-----|
| | | AVERAGE (W) | PEAK (kW) | | oz. | gr. |
| DC-8 | 4377BM | 5.0 | 2 | 1.05 + .015f | 3.0 | 85 |
| | 4370DM | 0.5 | 1 | 1.05 + .010f | 0.1 | 3 |
| DC-18 | 4379BM | 0.5 | 1 | 1.05 + .005f | 0.1 | 3 |
| | 4378BM | 5.0 | 2 | 1.05 + .015f | 3.0 | 85 |
| | 4375GM | 10.0 | 2 | 1.05 + .015f | 4.0 | 115 |

3.5 mm (M), DC to 26.5 GHz (Low / Medium Power)

| FREQUENCY RANGE (GHz) | MODEL | POWER | | VSWR* (max.) | | WEIGHT | |
|-----------------------|-------|-------------|-----------|---------------|---------|--------|-----|
| | | AVERAGE (W) | PEAK (kW) | DC-18 | 18-26.5 | oz. | gr. |
| DC-26.5 | 4380M | 0.5 | 1 | 1.05 + .0075f | <1.25 | 0.2 | 6 |

* f represents frequency in GHz

Terminations

Outline Drawings

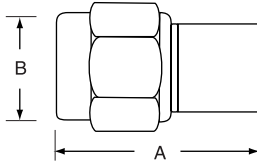

| MODEL | A (max.) | B DIAMETER (max.) |
|--------|----------|-------------------|
| 4370DM | .75 | .31 |
| 4379BM | .75 | .31 |
| 4380M | 1.02 | .40 |

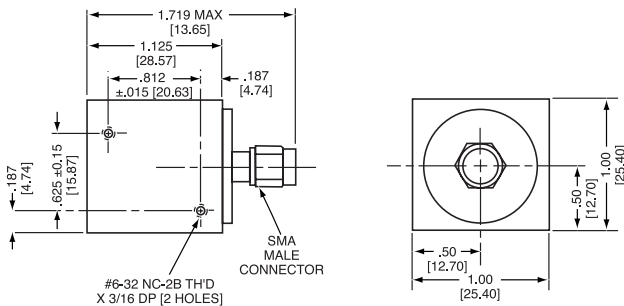
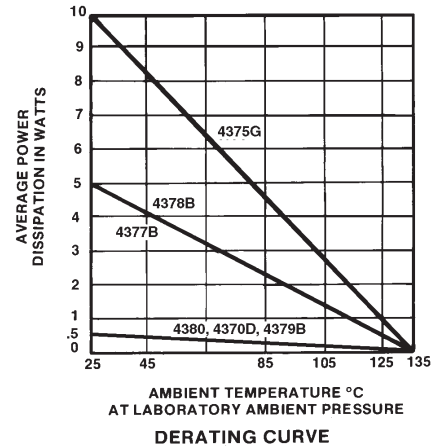

MODEL 4377 and 4378

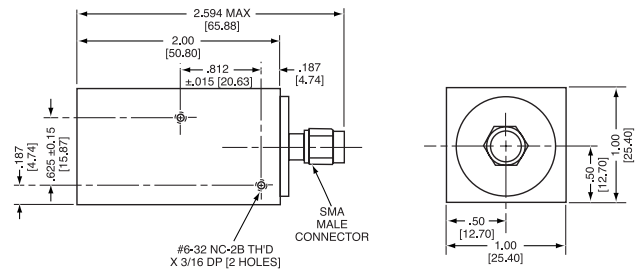

MODEL 4375

Dimensions in inches (mm in parentheses), unless otherwise specified.