



**ANATECH ELECTRONICS INC**  
RF & Microwave Filters & Products

# 1621 MHz Ceramic Bandpass Filter

**Part Number: AM1621B1338**



## Electrical specifications

**Center Frequency:** 1621 MHz  
**Bandwidth:** 10.5 MHz  
**VSWR:** 1.5:1  
**Input / Output Impedance:** 50 Ohms  
**Passband:** 1615.75-1626.25 MHz  
**Passband Insertion Loss:** 2.0 dB max  
**Passband Ripple:** 0.5 dB max  
**Rejection:** 55 dB min at 244-380 MHz  
**Rejection 2:** 55 dB min at 2483.5-2690 MHz  
**Power Handling:** 1 W

## Mechanical

**Mounting Method:** SMT  
**Dimensions:** 13 x 12 x 4.5 mm

## Environmental

**Operating Temperature:** -20°C to +70°C  
**Storage Temperature:** -50°C to +90°C

**This product is RoHs compliant.**

## Outline Drawing:

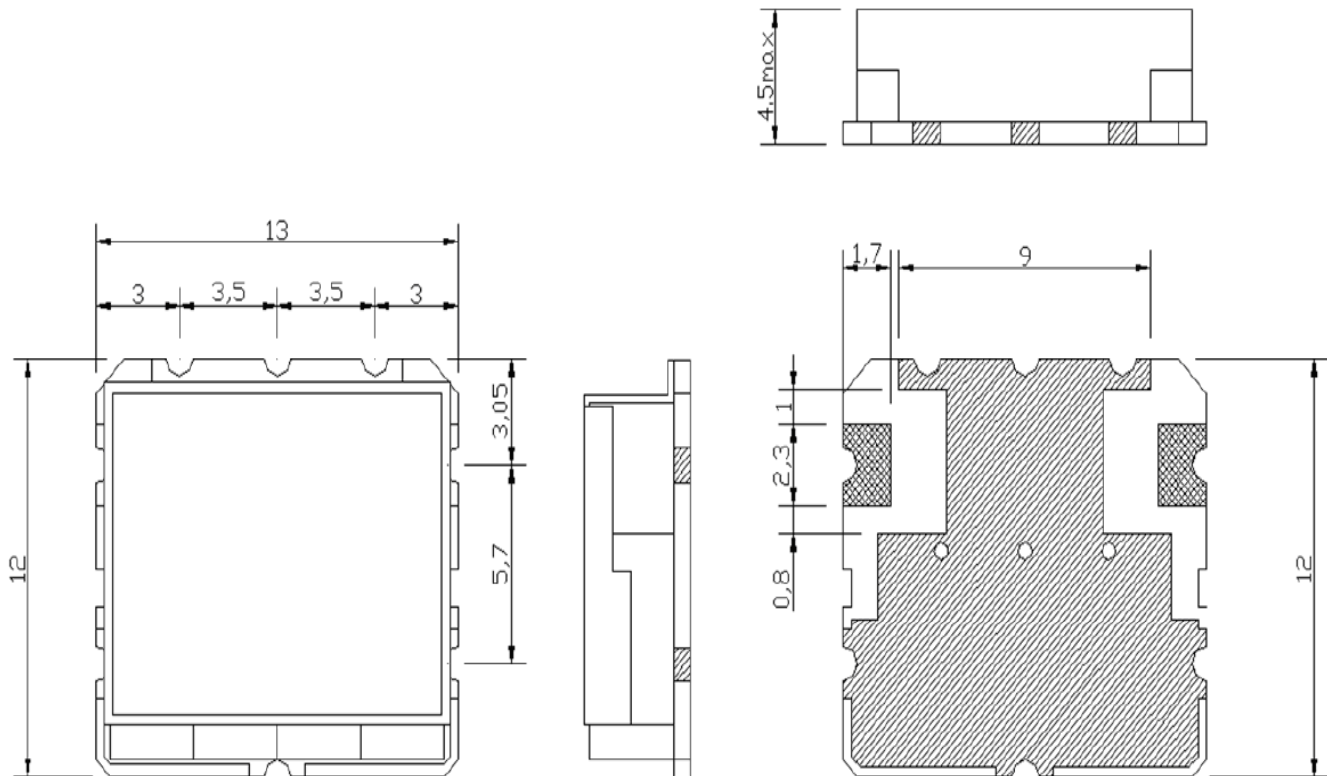

Tolerance: +/-0.01 inches [ +/- 0.3mm]

Angles: +/- 1 Deg.

\*Tolerance as shown unless otherwise specified in the datasheet electrical specification tables above.

\*When max dimensions are called out the above tolerances do not apply as long as it is under the max call out.



**ANATECH ELECTRONICS INC**  
RF & Microwave Filters & Products

# 1621 MHz Ceramic Bandpass Filter

**Part Number: AM1621B1338**



## Response Plot:

