



**1747 MHz Ceramic Bandpass Filter**

**Part Number: AM1747B54**

Center Frequency (Fo)	1747.5 MHz	(1710-1785 MHz)
Band Width	+/- 37.5 MHz	
Insertion Loss	1.7 dB	(2.5 dB max)
Return Loss	13 dB	(12 dB min)
Ripple	-	(- max)
Attenuation		
DC-1451 MHz	37 dB	(34 dB min)
1451-1677.5 MHz	18 dB	(10 dB min)
1677.5-1690 MHz	7 dB	(6 dB min)
1805 MHz	17 dB	(11 dB min)
Operating Temperature Range:	-40°C to +70°C	

**Outline Drawing:**

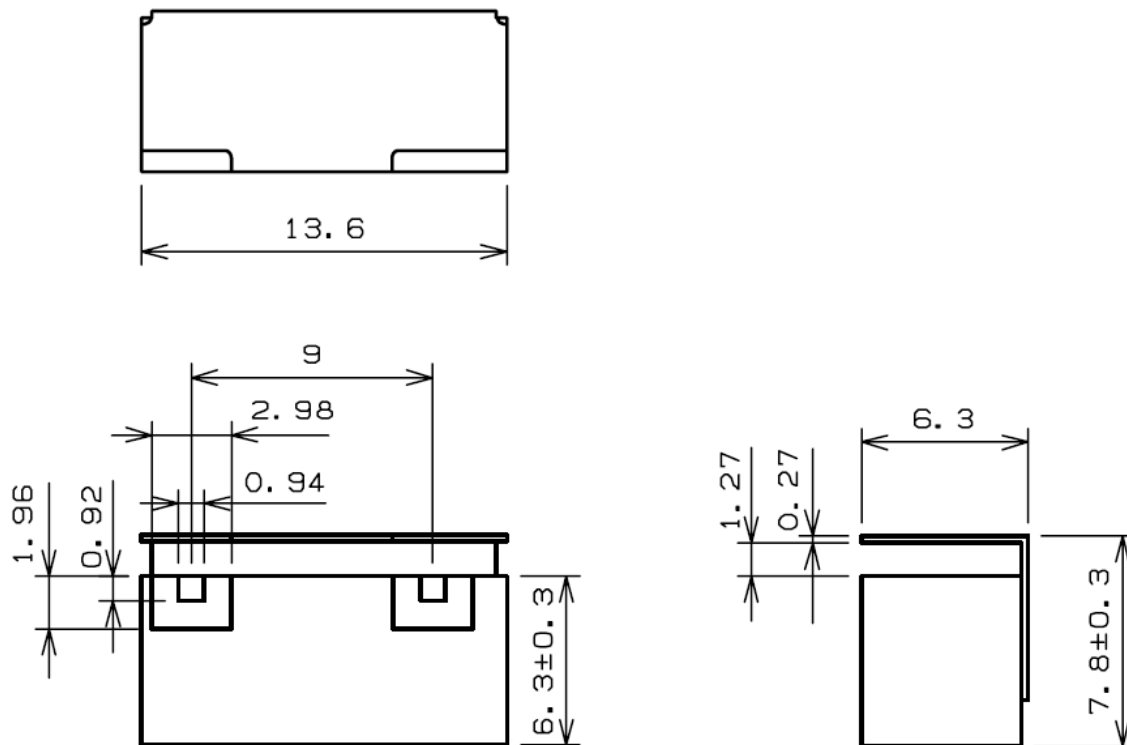



**1747 MHz Ceramic Bandpass Filter**

**Part Number: AM1747B54**

**Response Plot:**

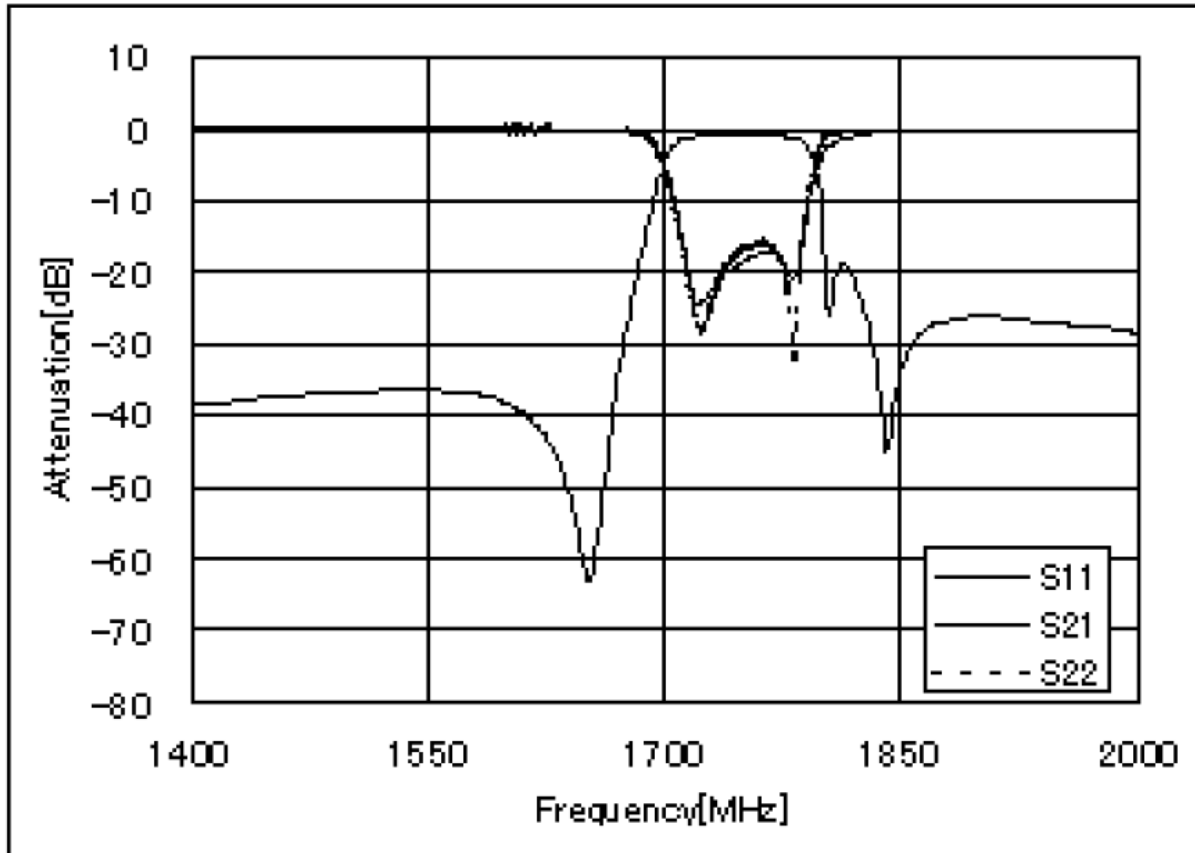



**1747 MHz Ceramic Bandpass Filter**  
**P/N AM1747B54**

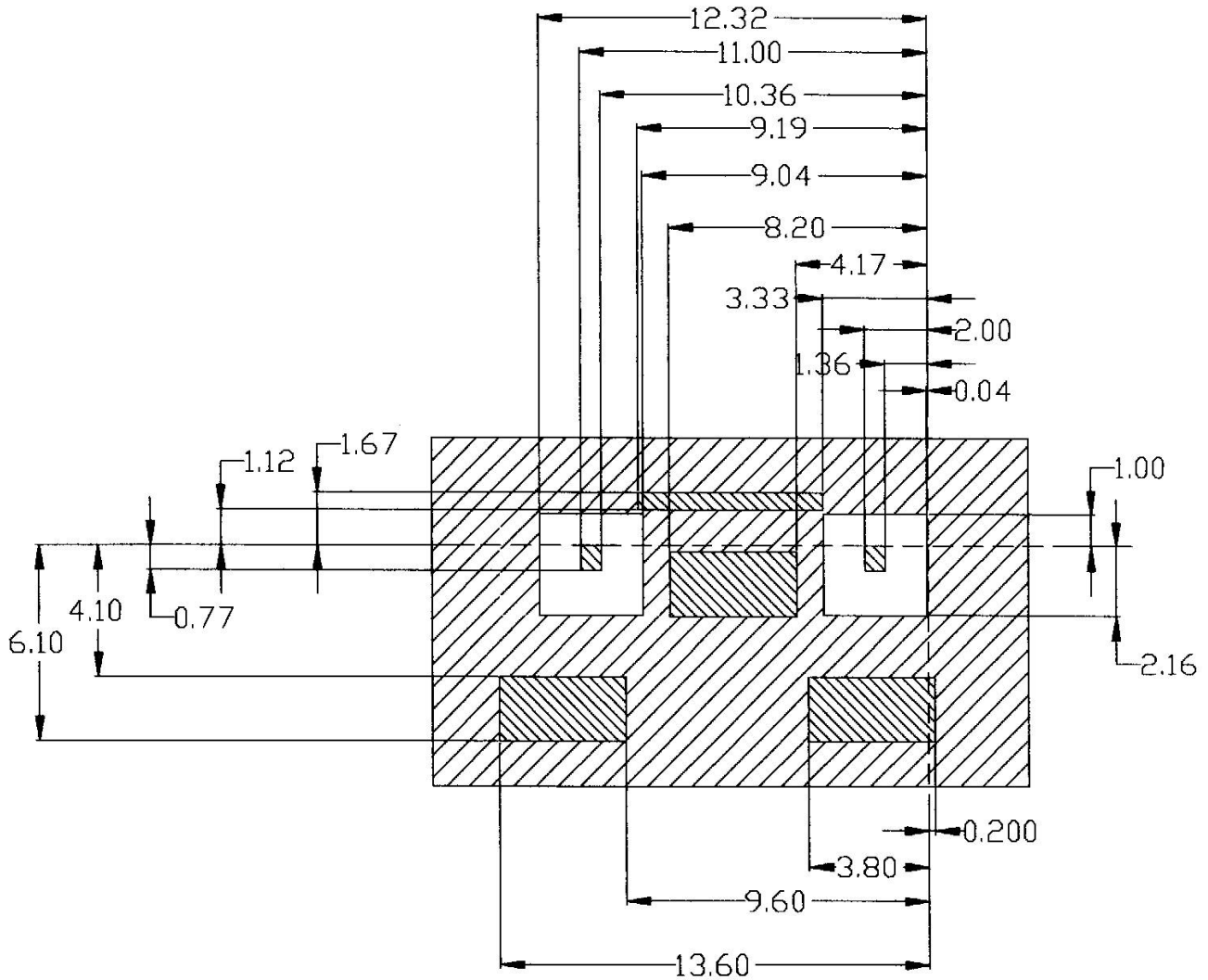

Exposed Conductor



Solder Resist over Conductor

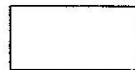

Solder Resist over Dielectric