



Electrical specifications

Center Frequency: 1440.4 MHz
Bandwidth: 25 MHz
VSWR: 1.7 : 1 min
Input / Output Impedance: 50 Ohms
Passband: 1427.9-1452.9 MHz
Passband Insertion Loss: 4.0 dB max
Passband Ripple: 1.0 dB max
Rejection: 23 dB min at 1475.9-1500.9 MHz
Rejection 2: 30 dB min at 1274.3-1299.3 MHz
Rejection 3: 50 dB min at 1735.1-1760.1 MHz
Power Handling: 3 watt max

Mechanical

Mounting Method: SMT
Dimensions: 13 x 12 x 4.5 mm

Environmental

Operating Temperature: -20°C to 70°C
Storage Temperature: -50°C to +90°C

This product is RoHs compliant.

Outline Drawing:

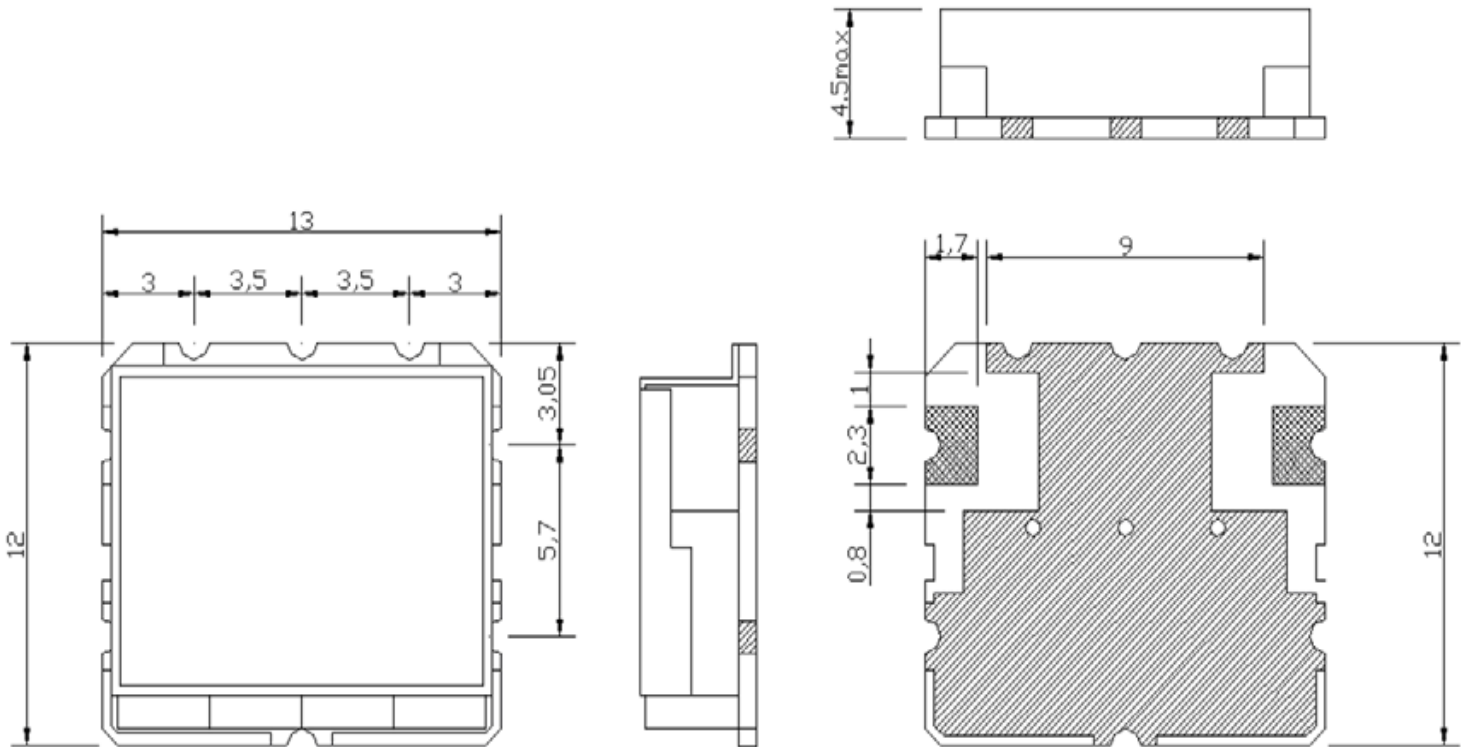

Unit:mm
Tolerance:±0.3