



Electrical specifications

Center Frequency: 2350 MHz
Bandwidth: 100 MHz
VSWR: 1.5 : 1
Input / Output Impedance: 50 Ohms
Passband: 2300-2400 MHz
Passband Insertion Loss: 2.5 dB max
Passband Ripple: 1.0 dB max
Rejection: 12 dB min at 2270 MHz
Rejection 2: 12 dB min at 2430 MHz
Power Handling: 30 dBm max

Mechanical

Mounting Method: SMT
Dimensions: 10.60 x 6.60 x 4 mm

Environmental

Operating Temperature: -40°C to 85°C
Storage Temperature: -50°C to +90°C

This product is RoHs compliant.

Outline Drawing:

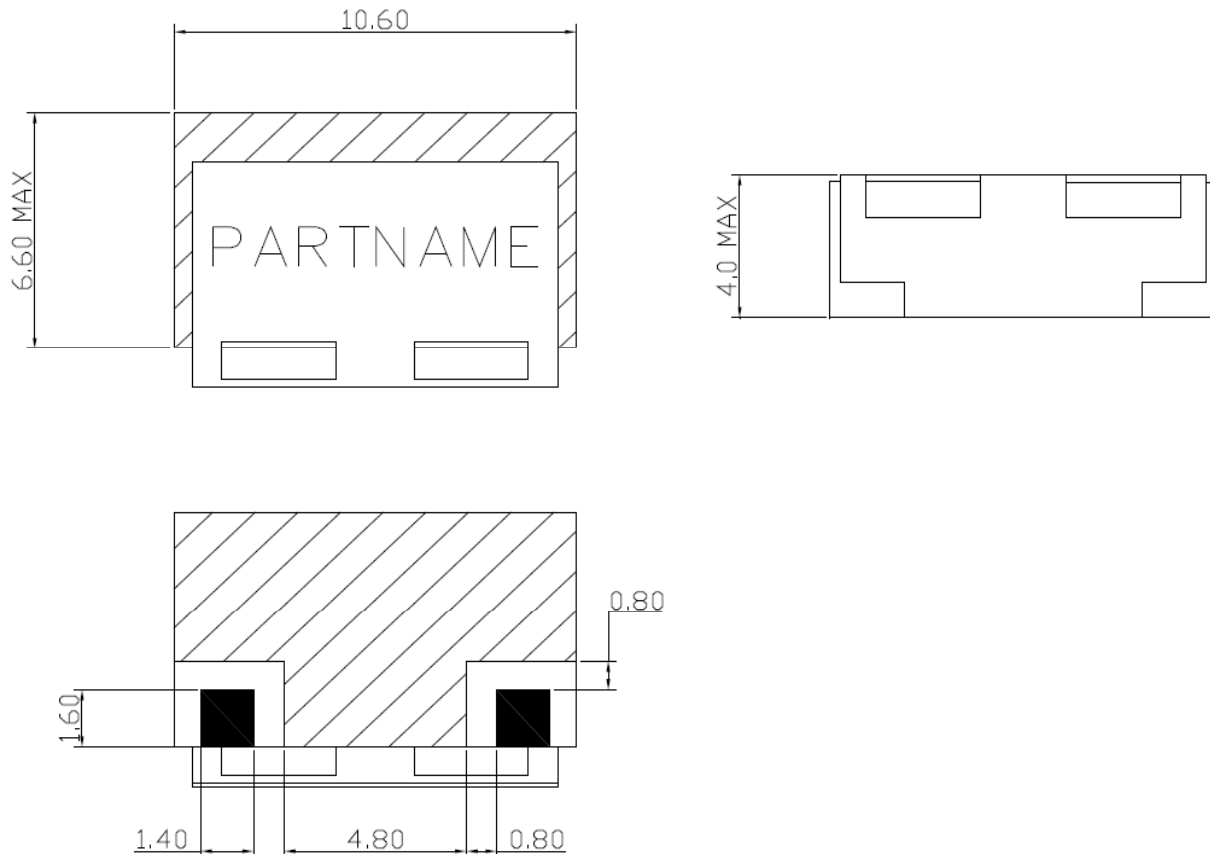



Response Plot:

