



**ANATECH ELECTRONICS INC**  
RF & Microwave Filters & Products

# 3500 MHz Ceramic Bandpass Filter

**Part Number: AM3500B1490**



## Electrical specifications

**Center Frequency:** 3500 MHz  
**Bandwidth:** 100 MHz  
**VSWR:** 15 dB min  
**Passband:** 3450-3550 MHz  
**Passband Insertion Loss:** 2.5 dB max  
**Passband Ripple:** 1.0 dB max  
**Rejection1:** 50 dB min at 3200 MHz  
**Rejection 2:** 50 dB min at 3800 MHz  
**Power Handling:** 1 Watt  
**Input / Output Impedance:** 50 Ohms

## Mechanical

**Mounting Method:** SMT  
**Dimensions:** 22.86 x 12.70 x 4.83 mm

## Environmental

**Operating Temperature:** -30°C to +70°C  
**Storage Temperature:** -50°C to +90°C

**This product is RoHs compliant.**

## Outline Drawing:

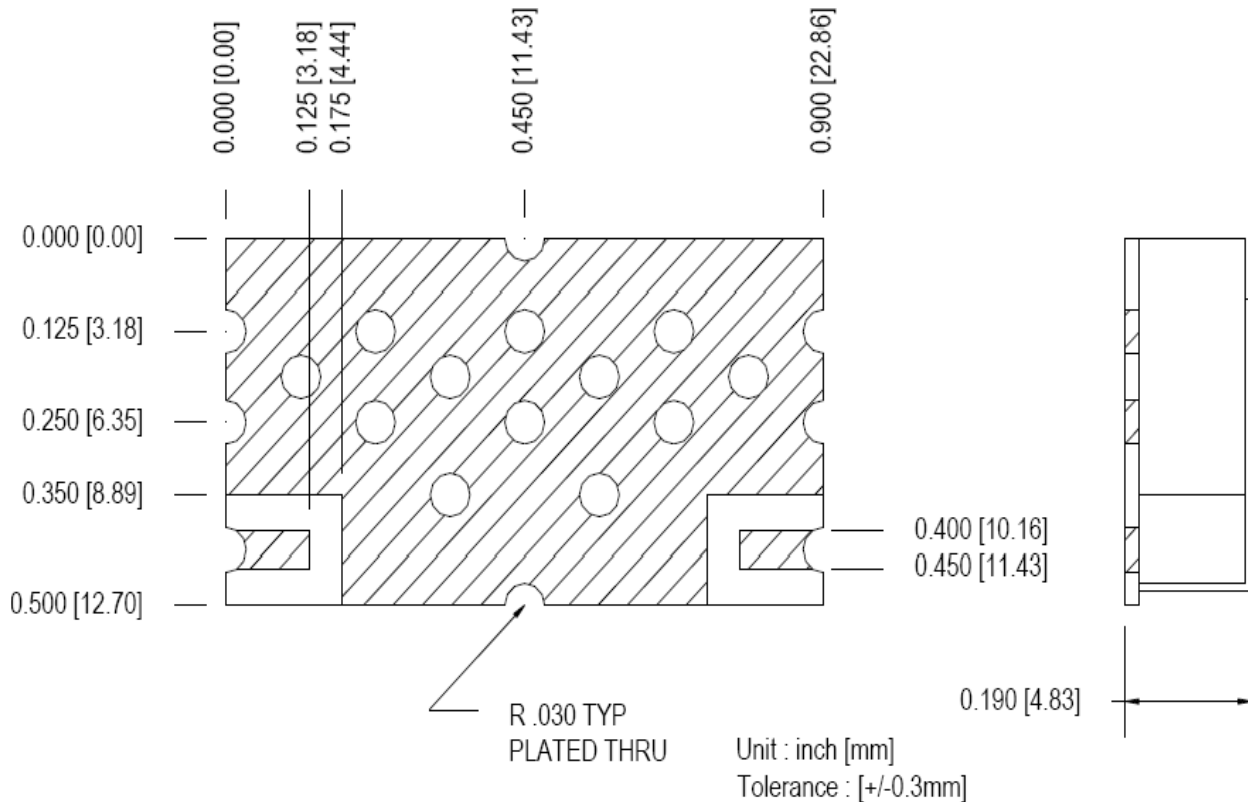



### Simulation Plot :

