



**ANATECH ELECTRONICS INC**  
RF & Microwave Filters & Products

# 2100 MHz Ceramic Bandpass Filter

**Part Number: AM2100B1298**



## Electrical specifications

**Center Frequency:** 2100 MHz  
**Bandwidth:** 166 MHz min  
**VSWR:** 1.33 : 1  
**Input / Output Impedance:** 50 Ohms  
**Passband:** 2017-2183 MHz  
**Passband Insertion Loss:** 1.5 dB max  
**Passband Ripple:** 1.0 dB max  
**Rejection:** 46 dB min at 1745 MHz  
**Rejection 2:** 25 dB min at 2380-2400 MHz  
**Rejection 3:** 46 dB min at 2800-4000 MHz  
**Power Handling:** 2 watt max

## Mechanical

**Mounting Method:** SMT  
**Dimensions:** 13 x 12 x 4.5 mm

## Environmental

**Operating Temperature:** -40°C to 85°C  
**Storage Temperature:** -50°C to +90°C

**This product is RoHs compliant.**

## Outline Drawing:

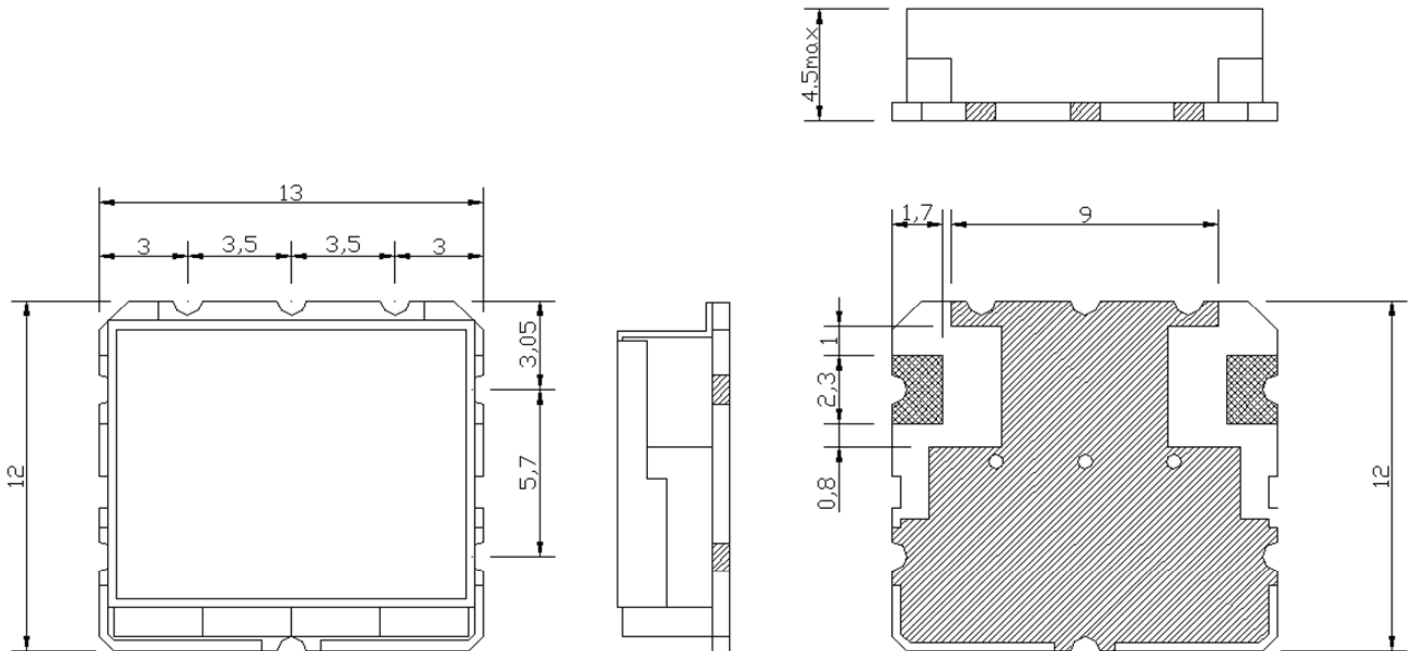

Unit:mm  
Tolerance:±0.3