



Electrical specifications

Center Frequency: 1804 MHz
Bandwidth: F0 ± 47.5 MHz
VSWR: 1.7 : 1 max
Input / Output Impedance: 50 Ohms
Passband: 1780.25-1827.75 MHz
Passband Insertion Loss: 1.5 dB max
Passband Ripple: 0.5 dB max
Rejection: 45 dBc min 1450 MHz
Rejection 2: 40 dBc min 2150 MHz
Power Handling: 0.5 watt

Mechanical

Mounting Method: SMT
Dimensions: 13.97mm x 12.7mm x 5mm
 (.550" x .500" x .197")

Environmental

Operating Temperature: -20°C to 55°C
Storage Temperature: -50°C to +90°C

This product is RoHs compliant.

Outline Drawing:

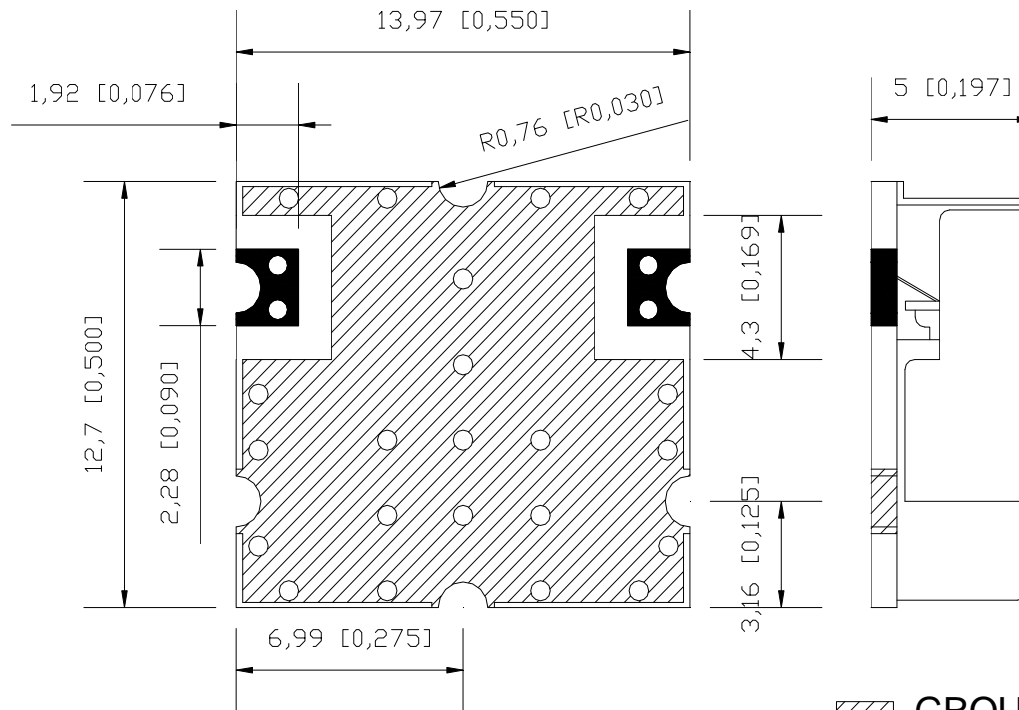

GROUND
 IN-OUT PORT
 UNIT : mm
 Tolerance : +/-0.2mm