



# 2185 MHz Ceramic Bandpass Filter

Part Number: AM2185B1593

**ANATECH ELECTRONICS INC**  
RF & Microwave Filters & Products



## Electrical specifications

**Center Frequency:** 2185 MHz  
**Bandwidth(BW):** 30 MHz  
**Insertion loss(Fo):** 2.5 dB max  
**Ripple in Bw:** 1.0 dB max  
**VSWR:** 1.5:1 Min  
**Attenuation 1:** 50 dB min @ 1616~1646 MHz  
**Attenuation 2:** 55 dB min @ 1980~2010 MHz  
**Attenuation 3:** 50 dB min @ 1980.4~2010.4 MHz  
**Attenuation 4:** 50 dB min @ 1790.8~1820.8 MHz  
**Attenuation 5:** 50 dB min @ 2344.8~2374.8 MHz  
**Group delay variation:** 10 nsec max  
**In/Out Impedance:** 50 Ohm  
**Input power:** 3 Watt max

## Mechanical

**Mounting Method:** SMT  
**Dimensions:** 13 X 14 X 4.5 mm

## Environmental

**Operating Temperature:** -45 to +85° C  
**Storage Temperature:** -55 to +95° C  
**Shock:** 20 G. 11ms  
**Vibration:** 20 G. 5 to 200 MHz

This product is RoHs compliant.

## Outline Drawing:

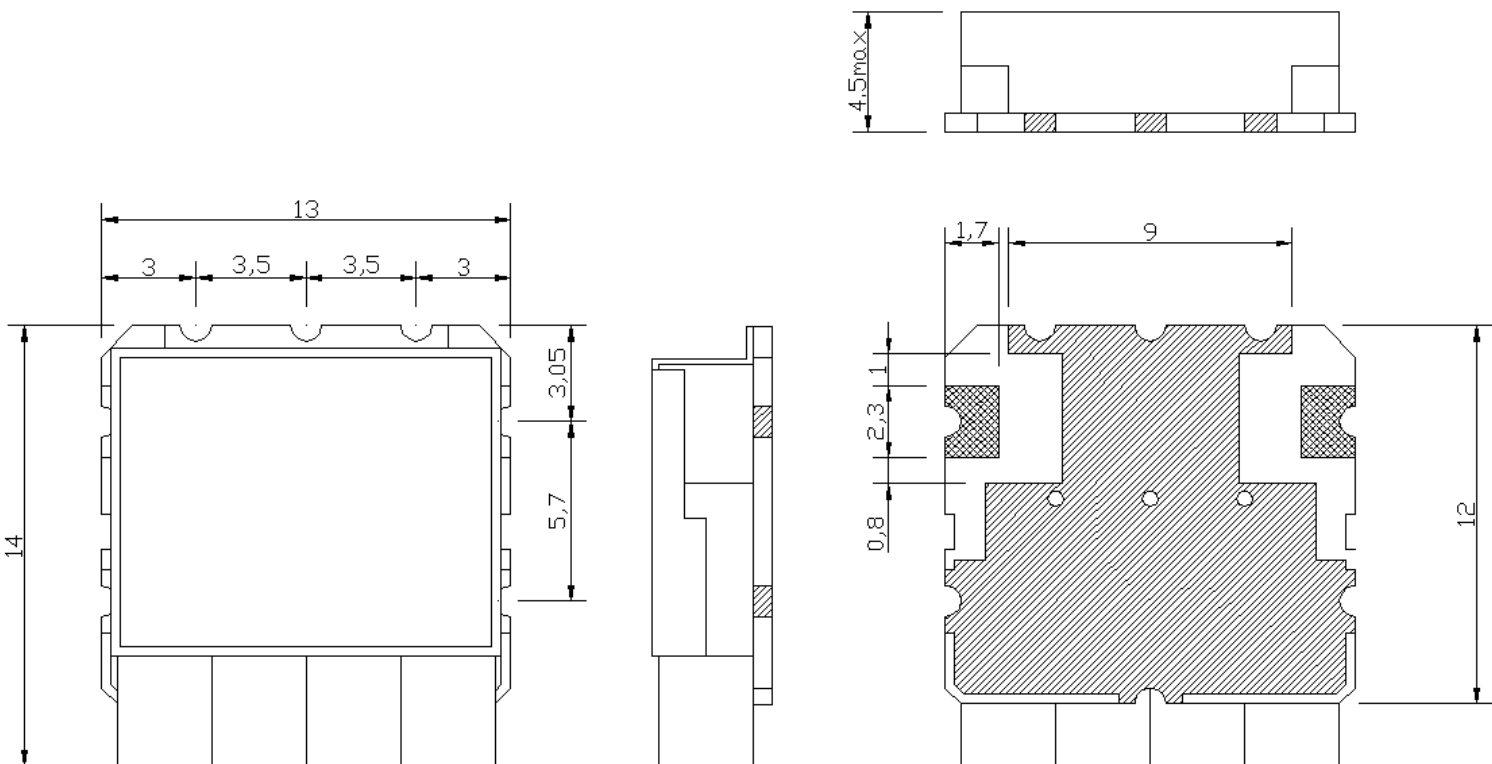

Unit:mm  
 Tolerance:±0.3