

NOTES

1. HOUSING COLOR: SEE TABLE
2. MATING HOUSING: 35150-0100
3. APPLICABLE TERMINAL: 35746-0\*10
4. APPLICABLE TPA: 35182-019\*

TRADE MARK  
(MK2)

CAVITY NO.  
(A1,A2,A3...)

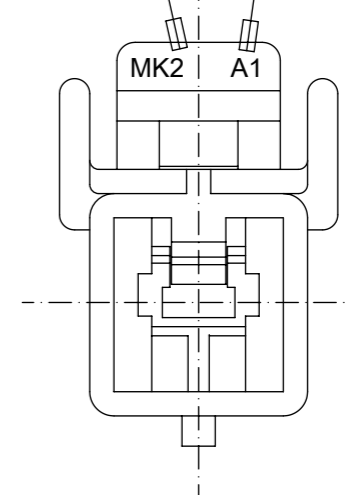

PRE-RELEASE  
REFERENCE  
USE ONLY

NO	PRODUCT		MATERIAL	
	PART NO	MATERIAL NO	COLOR	DESCRIPTION
1	35151-0110	351510110	NATURAL	PBT (UL94V-0)
2	35151-0112	351510112	RED	
3	35151-0114	351510114	BLUE	
4	35151-0119	351510119	NATURAL	PBT/PC

SYMBOLS		THIS DRAWING CONTAINS INFORMATION THAT IS PROPRIETARY TO MOLEX ELECTRONIC TECHNOLOGIES, LLC AND SHOULD NOT BE USED WITHOUT WRITTEN PERMISSION	
▽ = 0	mm	SCALE	4:1
▽ = 0	GENERAL TOLERANCES (UNLESS SPECIFIED)		
▽ = 0	ANGULAR TOL ± 1.0°		
▽ = 0	4 PLACES	±	
▽ = 0	3 PLACES	±	
▽ = 0	2 PLACES	±	
▽ = 0	1 PLACE	± 0.3	
▽ = 0	0 PLACES	±	
■ = 0	DRAFT WHERE APPLICABLE MUST REMAIN WITHIN DIMENSIONS		
▽ = 0	THIRD ANGLE PROJECTION		
CURRENT REV DESC:		EC NO: 617086	
		DRWN: SCHONG03	2019/05/12
		CHK'D: JBJIN	2019/05/16
		APPR: YSKIM02	2019/05/16
INITIAL REVISION:		DRWN: MHJEONG	2000/05/25
		APPR: YUNSIKKIM	2007/09/10
DOCUMENT NUMBER		DOC TYPE	DOC PART
SD-35151-0110		PSD	001
REVISION		C1	
MATERIAL NUMBER		CUSTOMER	SHEET NUMBER
SEE TABLE		GENERAL MARKET	1 OF 1

DOCUMENT STATUS	RELEASE DATE
-----------------	--------------